

SINGER® FUTURA™ “Lipstick” Cosmetic Case

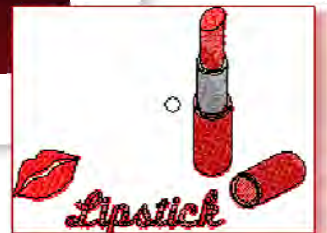
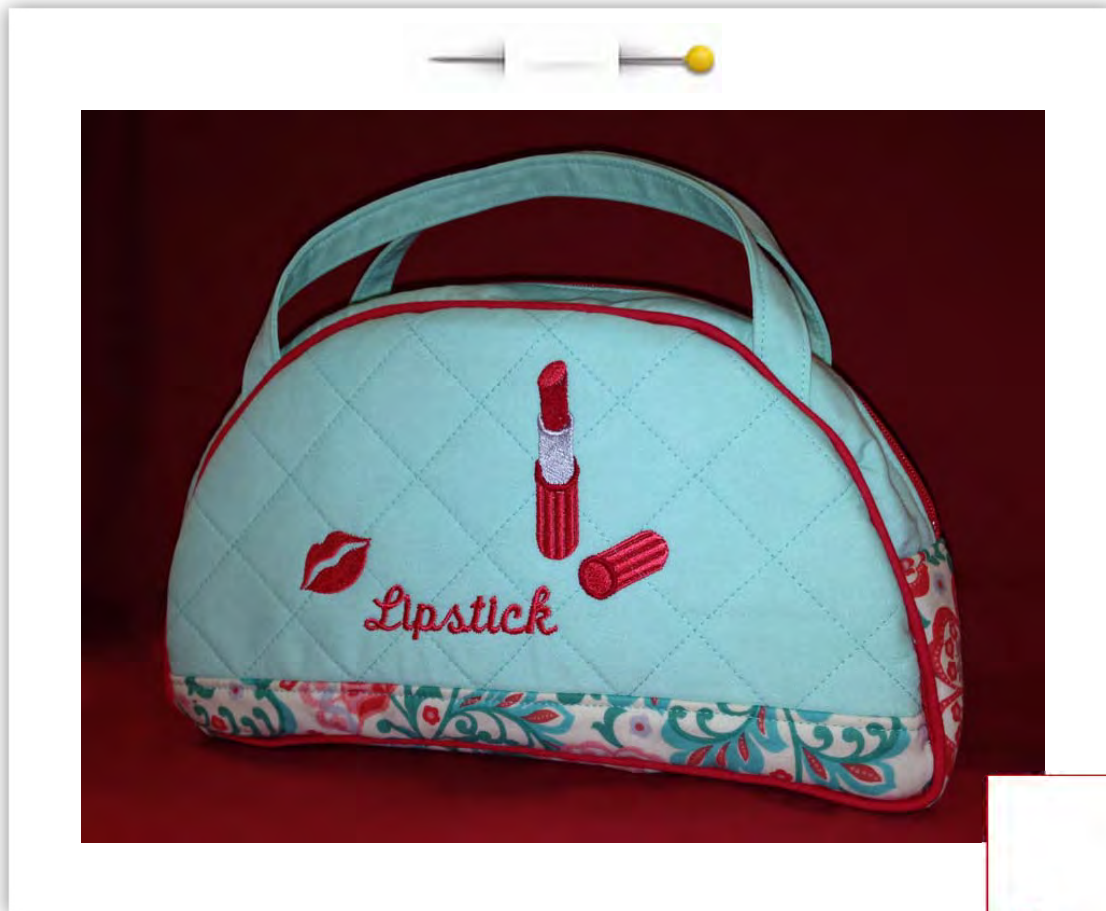

Using your own art work for digitizing is a great way to let your creativity flow with embroidery. Most art work is not “digitizing” ready, however. There are special “tools” built into the software for the SINGER® FUTURA™ sewing & embroidery machine to clean up graphic files so that they are ready to digitize. Have fun experimenting with these tools as you create this cute cosmetic case!

Shopping List:

- | | |
|---|---|
| <input type="checkbox"/> ½ yard Fabric A – solid (Case front & back) | <input type="checkbox"/> Ruler |
| <input type="checkbox"/> ¼ yard Fabric B – print (Case bottom & lining) | <input type="checkbox"/> Water soluble fabric marking pen |
| <input type="checkbox"/> 1 package of ½” piping | <input type="checkbox"/> Tear-away stabilizer |
| <input type="checkbox"/> ½ yard fusible low loft batting | <input type="checkbox"/> All-purpose thread |
| <input type="checkbox"/> One 14” zipper | <input type="checkbox"/> Machine embroidery threads |
| <input type="checkbox"/> Temporary fabric spray adhesive | <input type="checkbox"/> Bobbinfil thread for bobbin |

Fabric Preparation:

Case Front & Back	Fabric A (solid)	Cut one 12" x 16"
	Batting	Cut one 12" x 16"
Bottom Border	Fabric B (print)	Cut two 1 $\frac{3}{4}$ " x 11 $\frac{1}{4}$ "
	Batting	Cut two 1 $\frac{3}{4}$ " x 11 $\frac{1}{4}$ "
Zipper Inset	Fabric A (solid)	Cut two 2 $\frac{1}{4}$ " x 15 $\frac{1}{4}$ "
	Lining (print)	Cut two 2 $\frac{1}{4}$ " x 15 $\frac{1}{4}$ "
	Batting	Cut two 2 $\frac{1}{4}$ " x 15 $\frac{1}{4}$ "
Case Bottom	Fabric B (print)	Cut two 3 x 16 $\frac{3}{4}$ " (one for lining)
	Batting	Cut one 3 x 16 $\frac{3}{4}$ "
Handles	Fabric A (solid)	Cut two 2" x 13"
Case Front & Back Lining		Cut two from pattern provided (see last page)

1. Quilting the Fabric: To save time as well as fabric, both the front and back of the cosmetic case are cut from one single quilted fabric piece. To do this, apply the fusible batting to the wrong side of the 12" x 16" case front & back piece, following manufacturer's instructions. Mark diagonal lines across the fabric with a water soluble marker. Lines should be about 1" – 1 $\frac{1}{4}$ " apart. Mark diagonal lines going the opposite direction to form a grid.
2. Thread the top of the machine and bobbin with all-purpose thread. Using a straight stitch with a slightly longer length, stitch on the lines to quilt the fabric.
3. Once the fabric is quilted, set up the machine for embroidery. Fill the bobbin with bobbin thread and set the bobbin in the bobbin case. Place the fabric in the large hoop along with a piece of tear-away stabilizer underneath the fabric. Set the hoop onto the embroidery arm of the machine. The quilted fabric is ready to be embroidered.
4. Before you start to embroider, make a fabric sandwich for all of the remaining quilted fabric pieces (except for the handle strips, which are not quilted). To make a fabric sandwich, apply the batting piece to the wrong side of the coordinating fabric piece. Lightly spray the batting side with the fabric adhesive spray, then place the coordinating lining piece to the other side of the batting. Set aside until further instructed.

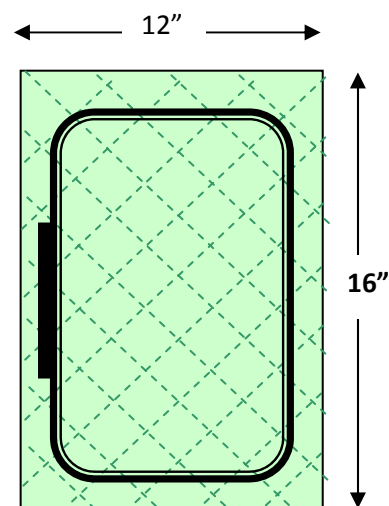

At the Computer:

- Both the “lips” and the “lipstick” graphic files are included in the .zip, so save them to your computer.

Hint: An easy way to organize files that you download or create yourself is to create a new file folder within the software and title it, My Images. Then, save all of your graphic files that you wish to use when digitizing to this folder.

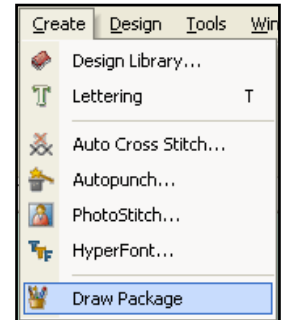

- Open the software

- Select **Create** on the main tool bar
- Select **Draw Package**
- Select **Open an existing image**, then **OK**
- Select the “lips” file from wherever you saved it



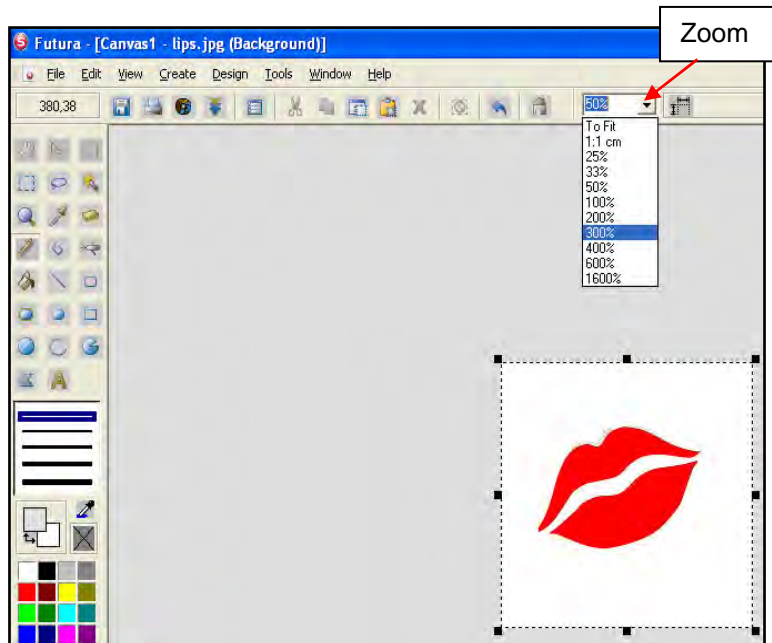

- The screen will now show the “lips” in the center area on the screen. There are many tools that can be used to edit the graphic file. At first glance the “lips” image appears to be rather clean. But, take a closer look. Use the **Zoom** function to enlarge the view of the image.

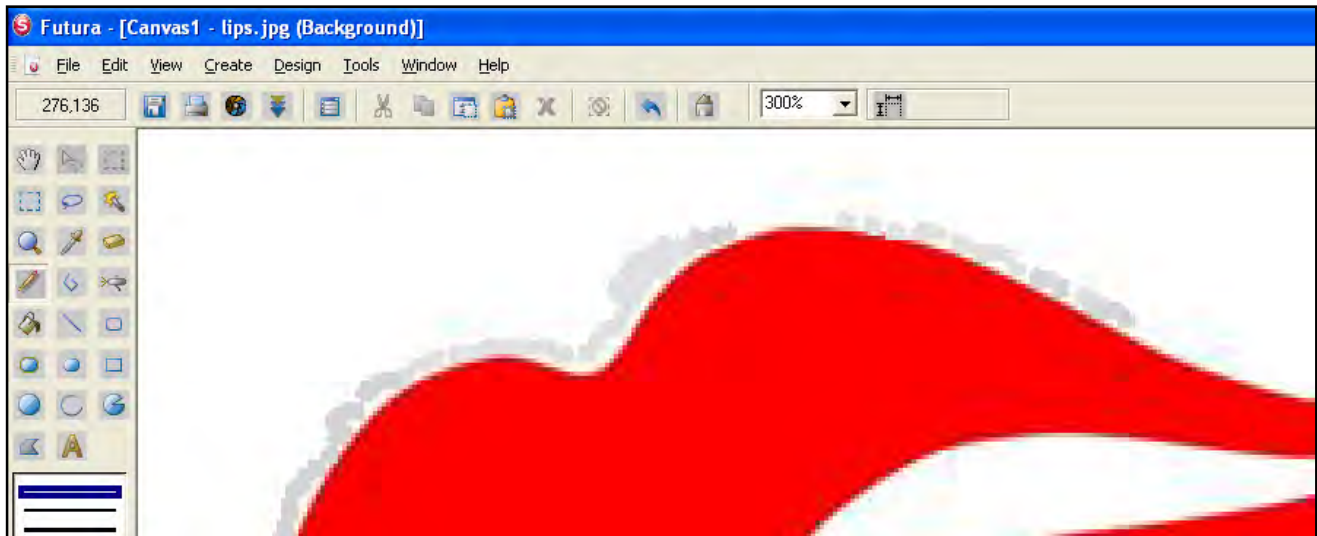

- Once you’ve zoomed-in, you’ll notice the “lips” image has many different colored dots in and around it. For best embroidery results, these colors should be cleaned up. There are many ways in which to clean up the image. You can use the tools on the left tool bar to manually clean-up the image, or you can use the “Image Processing” tool on the

main tool bar. You can use *Erase* to erase colored areas from the outer area and *Pen* or *Fill* to add in areas or change color. For more information on how to use these tools, see the featured technique in the December 2013 issue of *Embroidery Made Easy*. *Embroidery Made Easy* can be found at www.singerco.com.



9. Once the image is clean, exit the Draw function and save the file. The file will now appear in the hoop on the screen. Open the AutoPunch™ Wizard by selecting the AutoPunch™ icon on the main tool bar.  Follow the steps in the AutoPunch™ Wizard to digitize the design. For complete instructions on how to use the AutoPunch™ Wizard, see the featured technique in the September 2013 issue of *Embroidery Made Easy*. Save the design once it has been digitized.
10. Open a new screen. Select the **New** icon from the main tool bar.  Follow the process outlined above in Steps 6 through 9 to edit the lipstick graphic file.
11. When the image is clean, once again open the AutoPunch™ Wizard and follow the steps in the wizard to digitize the “lipstick”. In Step 5, **Classify blocks**, change the width to **6.0mm**. Special attention should be taken in Step 6, **Customize Stitch Blocks**. When there are multiple blocks in a design, the Wizard may order the blocks in a sequence that may not stitch out well. That is, placing blocks that should be stitched first at the end of the design and vice versa. When reordering the blocks, think about which blocks should stitch first and move them to the beginning of the stitching order. (See the illustration for recommended order.)

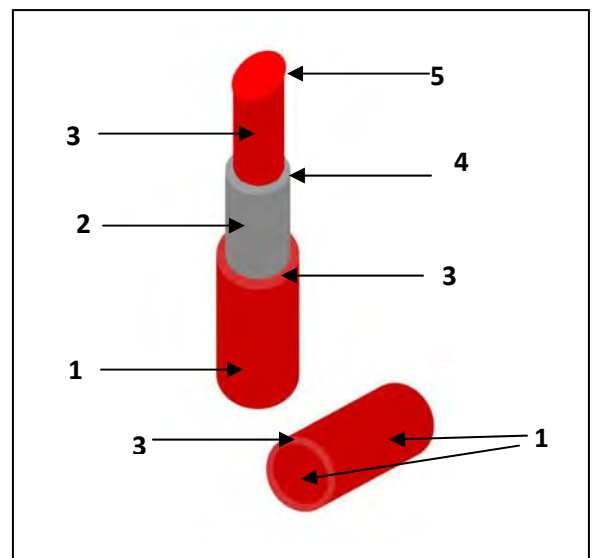

12. After the “lipstick” is digitized, you’ll need to add the other elements to complete the design. First, paste the “lips” into the design area.

- Select **File** from the main menu, then select **Paste Design**.
- Select the “lips” file from where you saved it, then select **OK**.
- Move the “lips” to the desired position while still in “ghost” form.
- Right click, then select **Apply**.

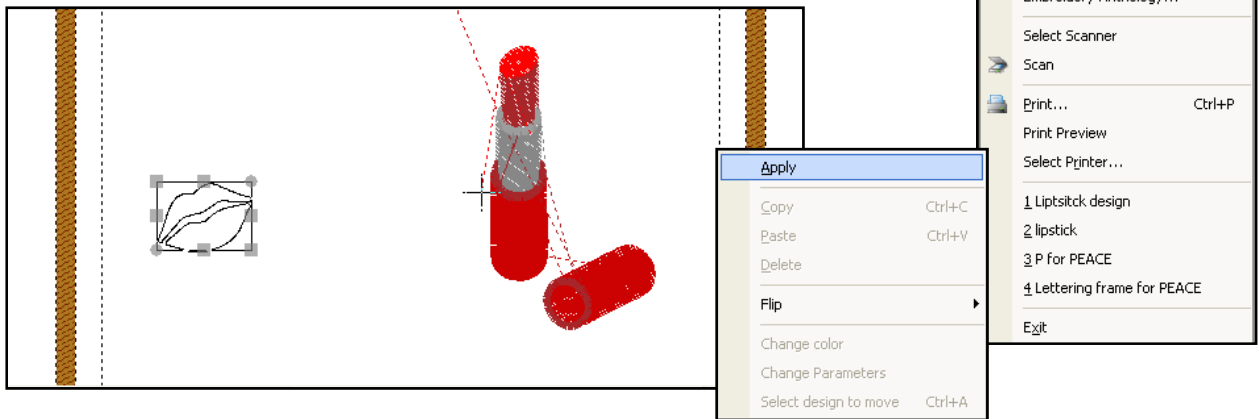

13. Lettering: Select the **Lettering** icon from the main tool bar.



- Type “**Lipstick**” in the Text box.
- Font - **Script 2**
- Height - **.45**
- Space - **0.00**
- Move the text to the desired position, right click and select **Stitch It**.

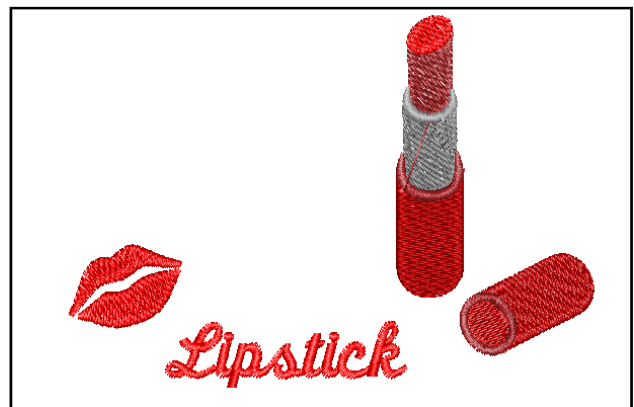

14. Editing the Design: Use the Editing tools to add more interest to the design. In this example, the type of stitch used for the lipstick case has been changed to add dimension.

- Select the **Editing** icon from the main tool bar. 
- Click on the bottom section of the lipstick tube. Right click and select **Embroidery Settings**.
- Select the **Stitch Type** tab, then select **Step 1/1**.
- Select **Apply**. The fill for the lipstick case has changed. Notice the angle of the stitches. The AutoPunch™ program automatically fills any area with a 45 degree angle. The angle of the stitches may look better if it was parallel to the bottom edge of the case.
- To change the stitch angle, click on one end of the stitch angle band, drag the end of the band to the new position.
- Right click and select **Stitch It!**
- Use this process to make changes to the lipstick case that is lying next to the lipstick tube. You'll want the fill type and stitch angle to look the same.

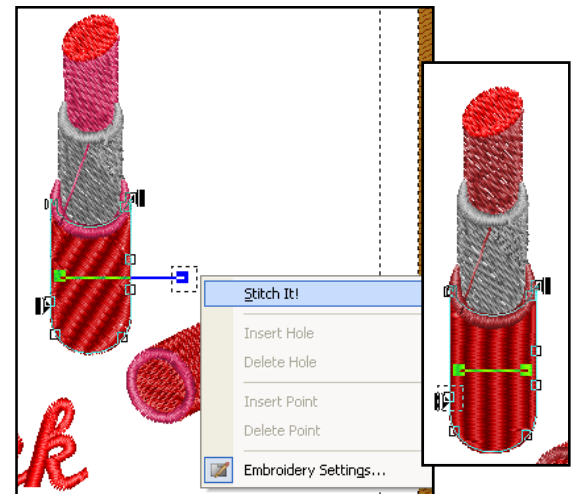
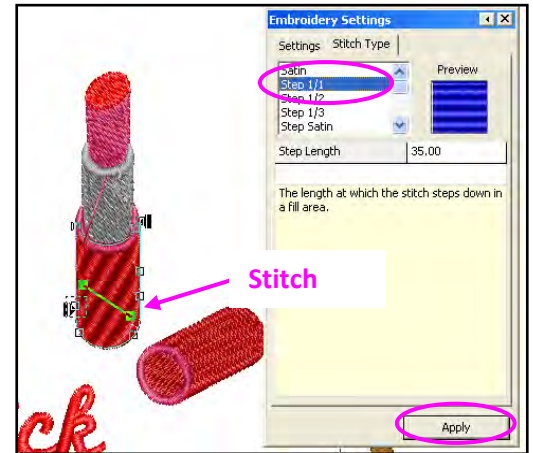

15. There is one final step once you've finished editing the design - that is, to move the design to the lower part of the hoop. The quilted fabric (that you've already prepared in the hoop) is going to be used for both the front and the back of the cosmetic case. In order for this to work, the design needs to be sewn at the bottom of the fabric.

- Exit from the Editing function by clicking on the Editing icon. 
- Select the Entire Design: Starting in the upper left corner of the design, drag the cursor over the entire design diagonally, then release the cursor button. The design is now in "ghost" form and can be moved to the bottom of the hoop. Click on design and move. Right click and select **Apply**.

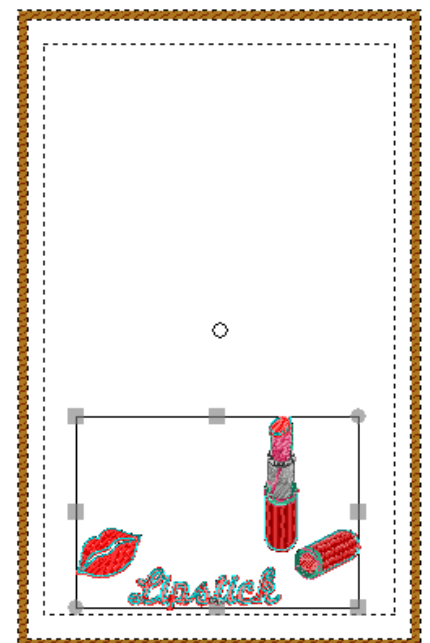

16. Send the Design to the Machine for Embroidery:

- Select the **Transmit to Machine** icon from the main tool bar. 
- Select **Send Design**, embroider the design. When the design is finished embroidering, remove the hoop from the machine and remove the stabilizer. Press.

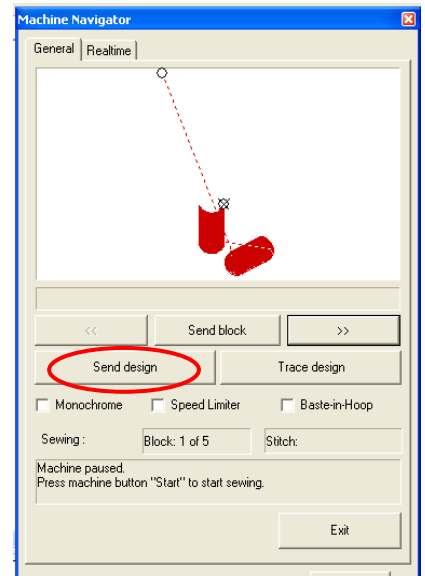

Sewing Directions:

17. Remove the embroidery unit from the machine. Remove the Embroidery Foot and replace it with the regular shank and General Purpose Foot. Thread the top of the machine and bobbin with all-purpose thread.
18. Cut the embroidered fabric in half. The embroidered piece is for the front and the remaining piece is for the back. Use the pattern piece provided to cut the front and back. Using a water soluble marker, transfer markings to the fabric.

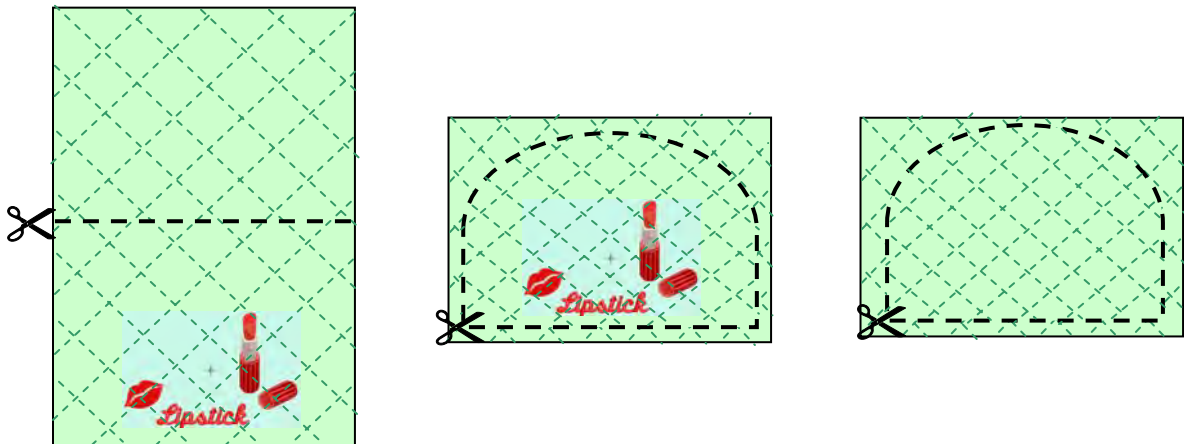

19. With right sides together, pin the prepared bottom borders to the lower edges of the case front and back pieces. Stitch using a $\frac{3}{8}$ " seam. *Please note, all seams will be $\frac{3}{8}$ " unless otherwise indicated.* Press seams towards the bands. Edge stitch along the seamlines.

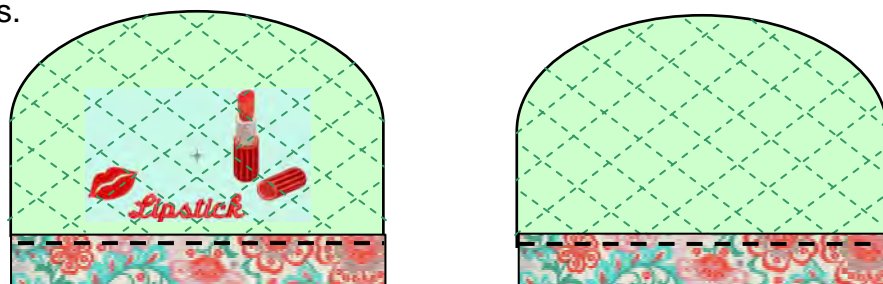

20. Lightly spray the wrong side (batting) with temporary fabric spray adhesive and apply the coordinating lining pieces.

21. Piping: Attach the Zipper Foot. Pin the piping to both the front and back pieces, placing raw edges together. To turn the corner, snip the seam allowance of the piping to the stitching, being careful not to cut the stitching. This will allow the piping to easily follow around the corner. Using a long straight stitch (4.8mm), and machine baste in place.

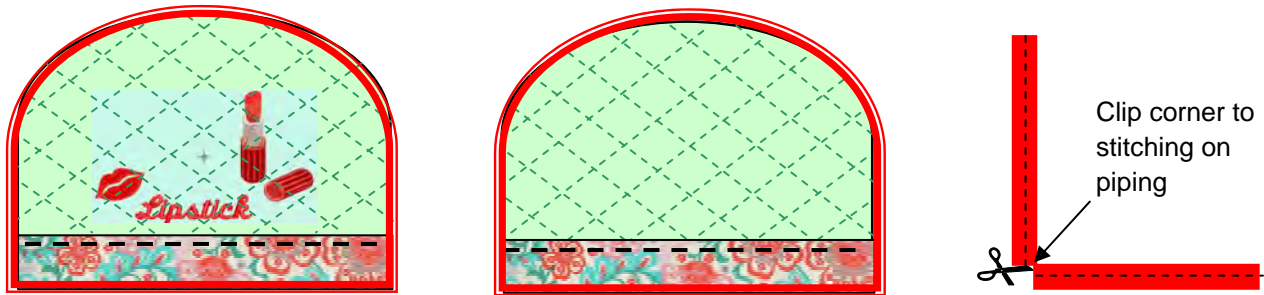

22. Handles: With right sides together, fold handle strips in half lengthwise, bringing raw edges together, pin. Stitch long edges together. Turn right side out, press and stitch along each side, close to the folded edges.

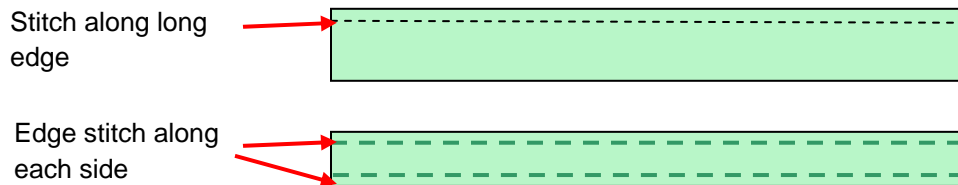

23. Place one end of a handle strip at placement dot on case front. Position the handle so that it lays parallel to the bottom edge. Baste the handle in the seam line close to the piping. Repeat with the other side of the handle. Attach the remaining handle strip to the case back piece in this same manner.

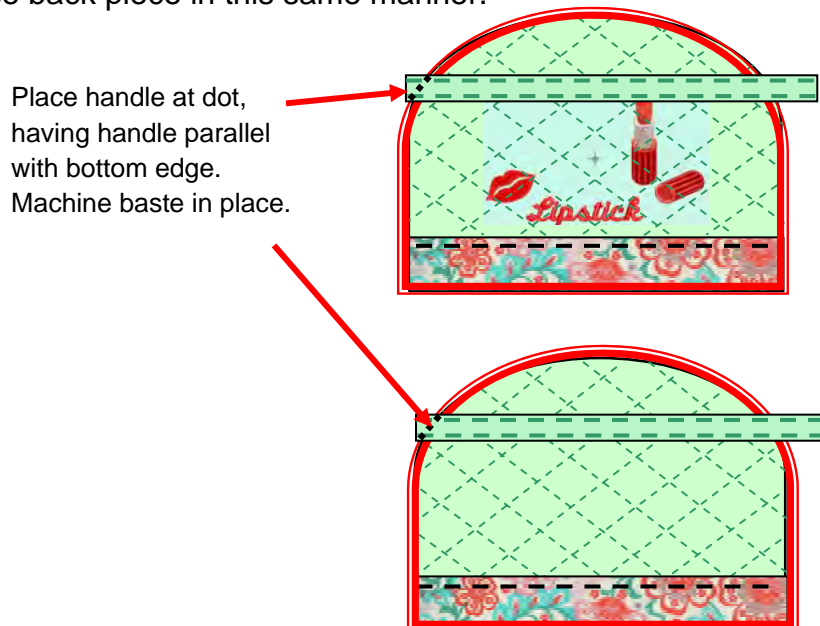

24. Zipper:

- a. Open the zipper. With right sides together, place one side of the zipper along the prepared zipper inset pieces, having raw edges together. Stitch about $\frac{1}{8}$ " from zipper teeth. If necessary, slide zipper tab out of the way to navigate around it.

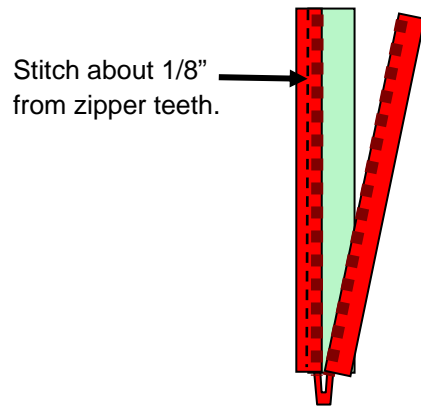

- b. With right sides together, pin one of the lining inset pieces to the same edge, sandwiching in the zipper. Stitch.

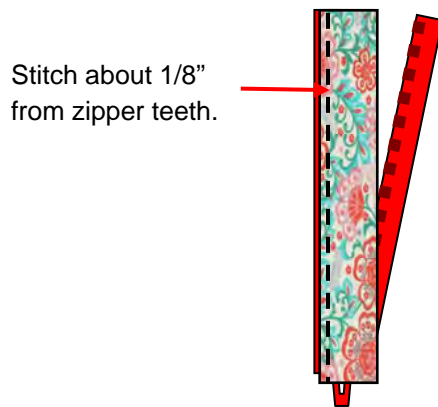

- c. Fold back the lining and fabric to expose the zipper. Press.

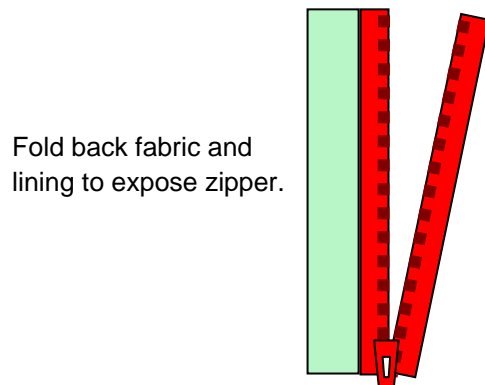

- d. Edge stitch close to the folded edge of the fabric.

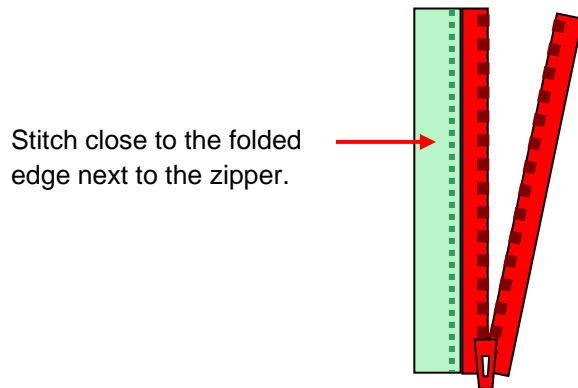

- e. Repeat this process to attach the other side of the zipper to the remaining zipper inset and zipper lining pieces. Close the zipper.

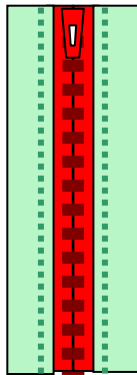

25. With right sides together, pin one end of the prepared bottom band to one end of the zipper piece. Stitch seam close to the zipper stop. With right sides together, pin the other end of the band to the other end of the zipper piece, forming a circle with the band. Stitch seam close to the zipper tab.

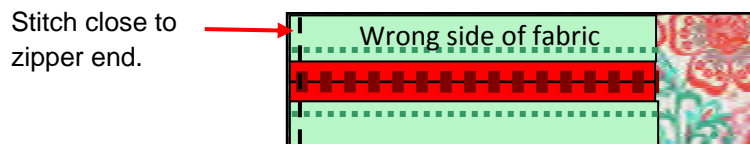

26. Press seams towards the band. Edge stitch close to the folded edges.

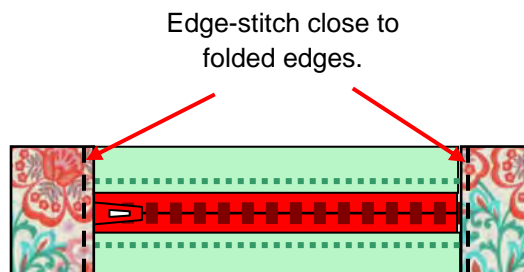

27. Fold the zipper piece in half to find the center of the strip. With a water soluble fabric marker, make a dot in the seam lines to mark the center of each side of the zipper inset.

Put a mark in the seam allowance on each side of the zipper inset to mark the center.

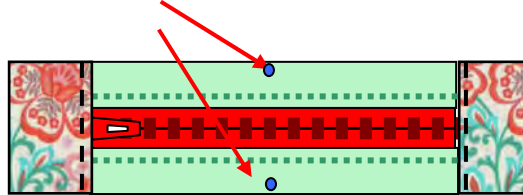

28. With right sides together and starting with the section with the zipper, pin one edge of the band to the top edge of the case front, matching the center marking on the band to the center mark on the case front. Using a Zipper Foot, stitch together, being careful not to catch handles in the seam and stopping seam about $\frac{3}{8}$ " from corners, backstitch. At corner, clip fabric to stitching to aid in turning the corner. Pin the remaining band along the bottom edge. Stitch the remainder of the band to the case front.

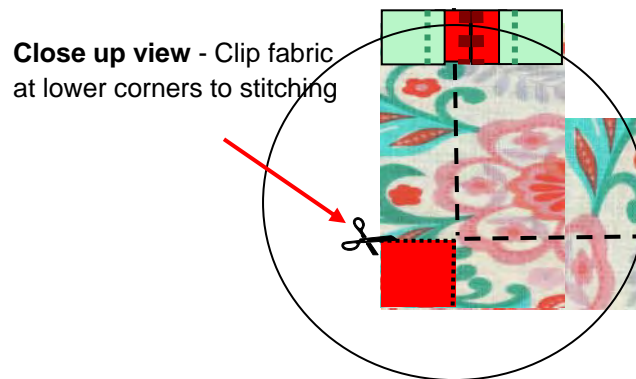

29. Turn right side out. Press.

SINGER is sewing made easyTM

