



## let's get to the basics

Your machine is out of the box and you have plenty of ideas waiting to get out, right? Let's get the basics out of the way. Before you start sewing, you'll have to wind a bobbin and then thread your machine. But don't be intimidated – it's easier than you think with Jubilant's friendly features. Once you've followed these quick and easy steps, simply select a stitch and you're ready to sew!



### the bobbin



- Place the empty bobbin on the bobbin winder shaft aligning the notch in the bobbin with the spring on the shaft.
- Slide the bobbin to the right until it snaps into place.
- Follow the numbered thread path to the bobbin and wind the thread clockwise 5-6 times around the bobbin then through the guide slit in the bobbin winder seat to cut the thread.

1.



- Push the start/stop button to activate the bobbin winder. Once the bobbin is full, winding will slow down for you to press the start/stop button.

2.



- Slide the bobbin to the left until it snaps into place.
- Lift the filled bobbin off the base and cut the thread with the built-in thread cutter in the bobbin winder seat.

3.

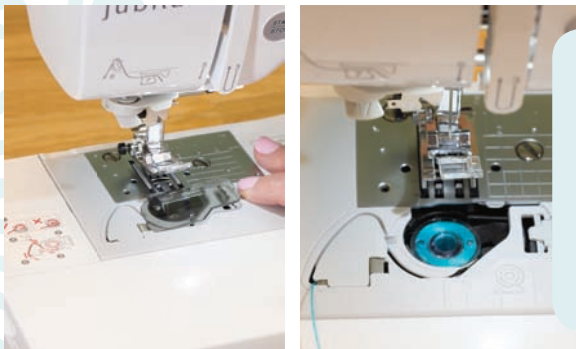

- Slide the bobbin cover latch to the right and remove the bobbin cover.
- Place the bobbin with the thread going counterclockwise and slide the thread through the needle plate cover. It will automatically cut your thread.
- Your bobbin is loaded.

4.

## the needle



- Using the Needle Up/Needle Down button raise the needle to the highest position. Place the presser foot in the up position.
- Turn off the machine.

1.

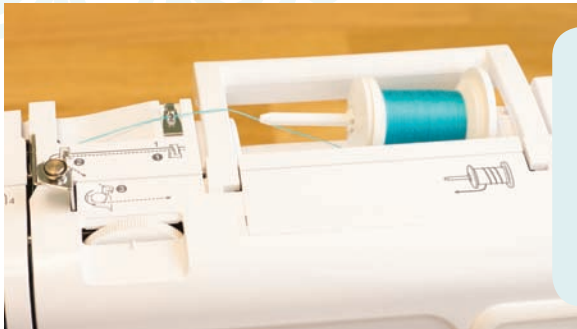

- Follow the numbered thread path shown on the machine.

2.



- Bring the thread around the needle threader with the thread seated in number 7 position. Lower the presser foot.

3.



- Cut off the excess thread using the built-in thread cutter on the side of the machine.
- To thread the needle push down on the needle threader lever to engage the needle threader and then release.

4.



- Pull the thread loop to the back and your needle is threaded.

5.

**baby lock**  
*Be* genuine collection

WWW.BABYLOCK.COM



XH3234-001