



KANGAROO™
sewing furniture

ASSEMBLY INSTRUCTIONS

Kookaburra

ITEM NO.: K3455 Teak
K3451 Ash White

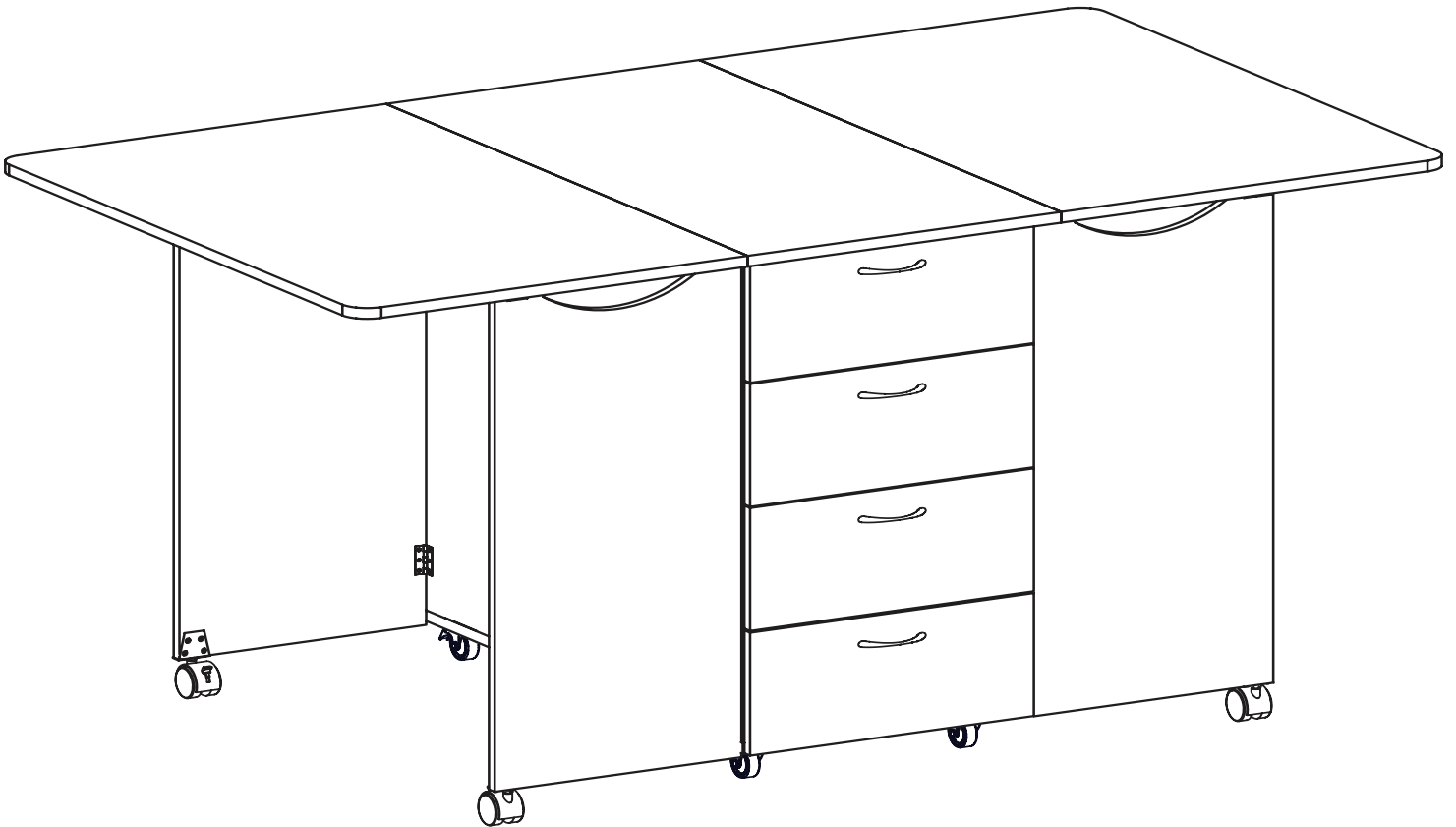

SEW IN COMFORT. SEW LONGER.™

Read the instructions carefully before starting. Please open and inspect the contents of boxes to see that all parts are included. You will need a Phillips head and a flat head screwdriver. A power screwdriver or cordless drill is preferable. Ensure that the Phillips head fits neatly and fully engages the screw to avoid damage to the screws. Make sure that you tighten all screws securely and tap wooden dowels all the way in.

Use and Care

Your cabinet normally requires a minimum amount of maintenance; however, the following points are worth noting:

Cleaning - To remove marks and enhance the surface, wipe with general purpose cleaner.

Caution - Do not use ammonia-based cleaning agents. Do not use harsh chemicals or abrasive cleansers. The surface can be wiped with a damp cloth but should be dried quickly.

Electrical and Hydraulic Lifts - Require annual lubrication.

Understanding How the Cam Fastener Works

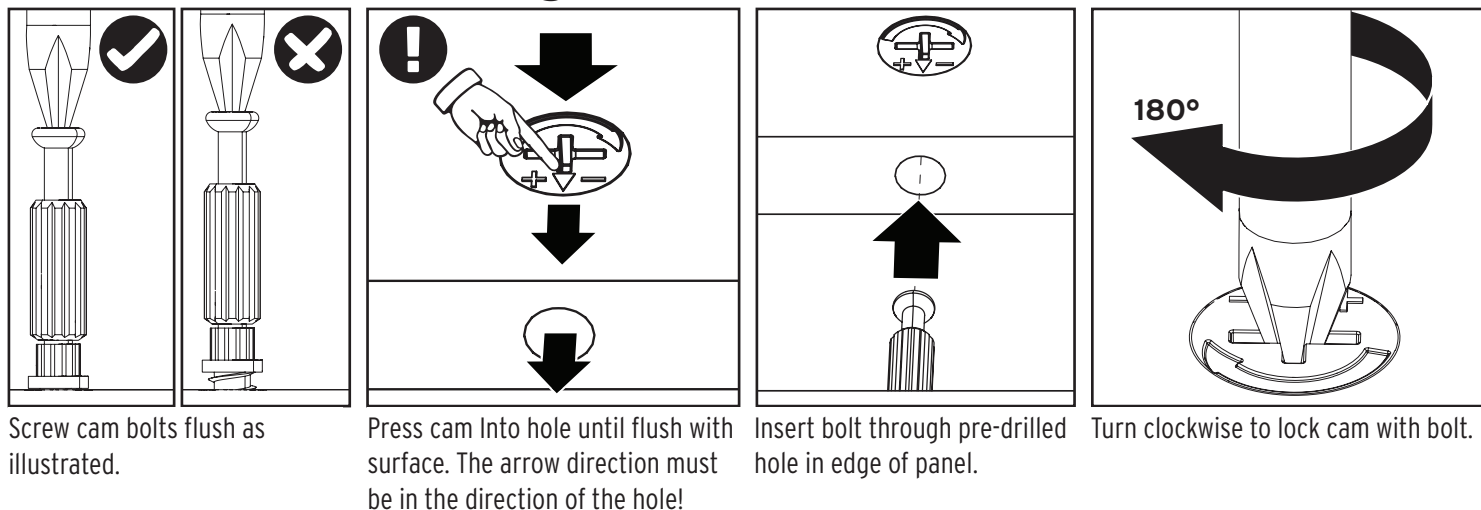

Parts List

ITEM	DESCRIPTION	QTY.	PACK.	ITEM	DESCRIPTION	QTY.	PACK.
Y	Back Panel	1	1 of 3	X	Left Side Panel	1	3 of 3
E	Shelf panel	3	1 of 3	Z	Right Side Panel	1	3 of 3
L1	Drawer Left Side	4	1 of 3	01	Left Gate Leg	2	3 of 3
L2	Drawer Right Side	4	1 of 3	02	Right Gate Leg	2	3 of 3
L3	Drawer Back	4	1 of 3				
L4	Drawer Bottom	4	1 of 3				
A1	Top Leaf Panel	2	2 of 3				
A	Top Panel	1	2 of 3				
G	Bottom	1	2 of 3				

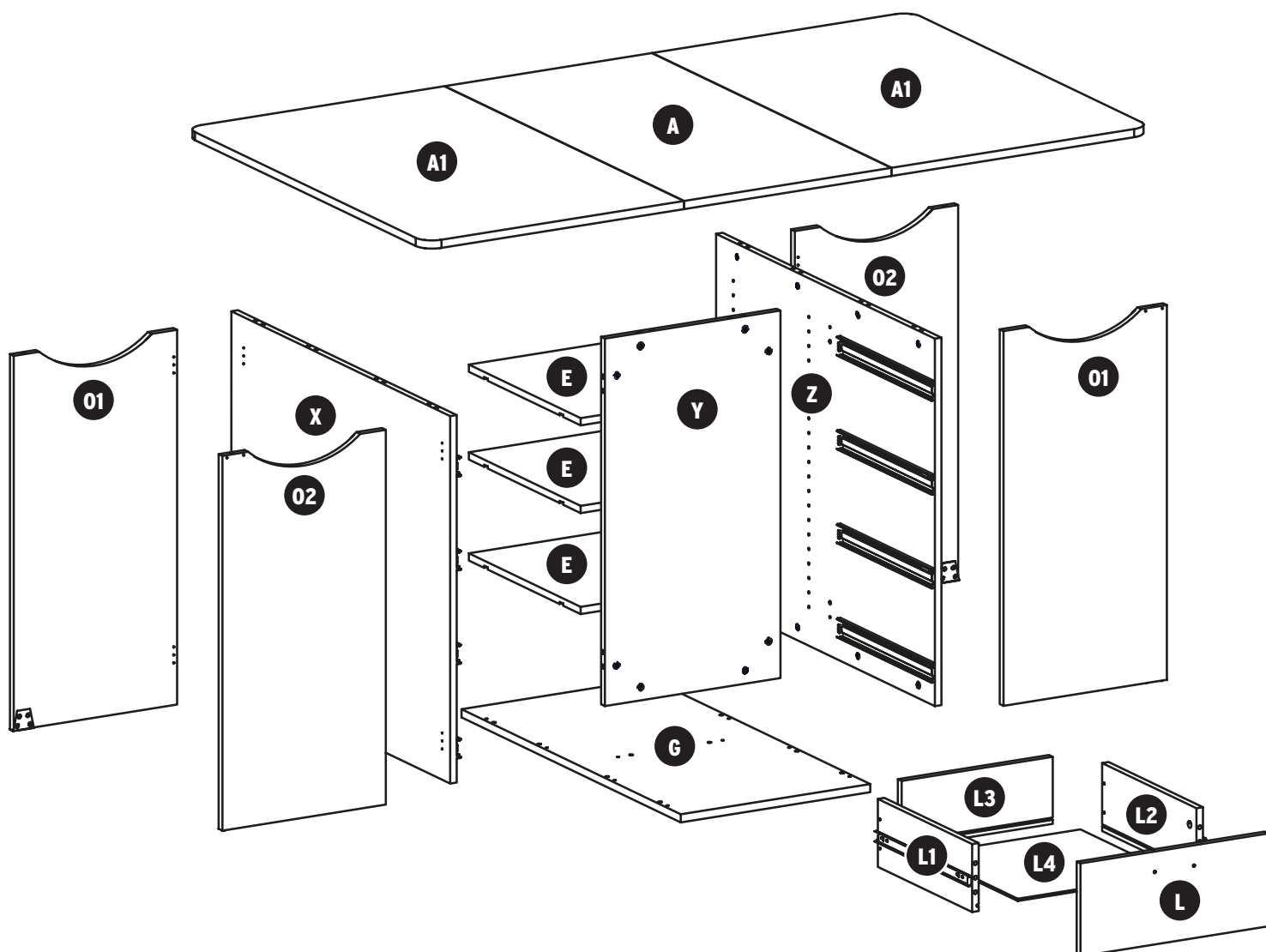

Parts List

ITEM	DESCRIPTION	QTY.	ITEM	DESCRIPTION	QTY.
c1	6x35 Cam Bolt	40	h1	Butt hinge	14
d1	8x30 Dowel Pin	30	h	Handle	4
c2	5/8" Cam Cover	40	b2	4x24 Fix Bolt	8
t1	Caster	4	b1	8x16 Fix Bolt	20
t2	Locking Plate Caster	5	s1	3.5x14 Screw	92
a	Wrench	1	s2	3x14 Screw	8
r3	14mm Spanner	1	s3	3.5x30 Screw	16
m	Magnet, Catch Plate	4	s5	Alignment Pin	4
			p1	Peg	12

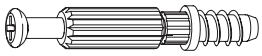

c1 6x35 Cam Bolt **x40**



c2 5/8" Cam Cover **x40**

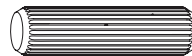

d1 8x30 Dowel Pin **x30**

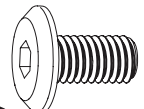

b1 8x16 Fix Bolt **x20**



b2 4x24 Fix Bolt **x8**



s1 3.5x14 Screw **x92**



s2 3x14 Screw **x8**



s3 3.5x30 Screw **x16**

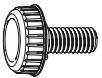

s5 Alignment Pin **x4**



a Wrench **x1**



h Handle **x4**

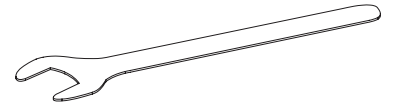

r3 14mm Spanner **x1**

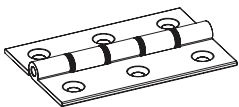

h1 Butt Hinge **x14**

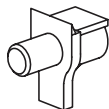

p1 Peg **x12**

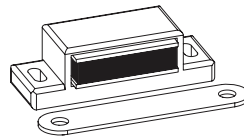

m Magnet **x4**
Catch plate **x4**

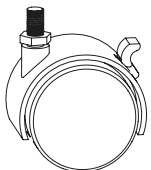

t1 Caster **x4**

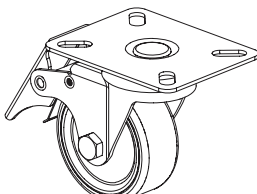

t2 Locking Plate Caster **x5**

Pre-installed parts



c5 Cam

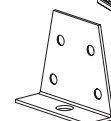

Caster Bracket



Drawer Runners

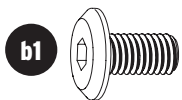

8x16 Fix Bolt **x20**

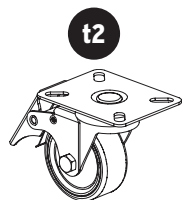

Locking Plate
Caster **x5**



Wrench **x1**

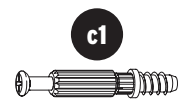

6x35 Cam Bolt **x10**

Step 1. Panel G assembly.

1. Fix casters **t2** to panel **G** with bolts **b1** as illustrated below using wrench **a** to tighten.
2. Turn panel over to side with care.
3. Install cam bolts **c1** into panel **G** as illustrated below.

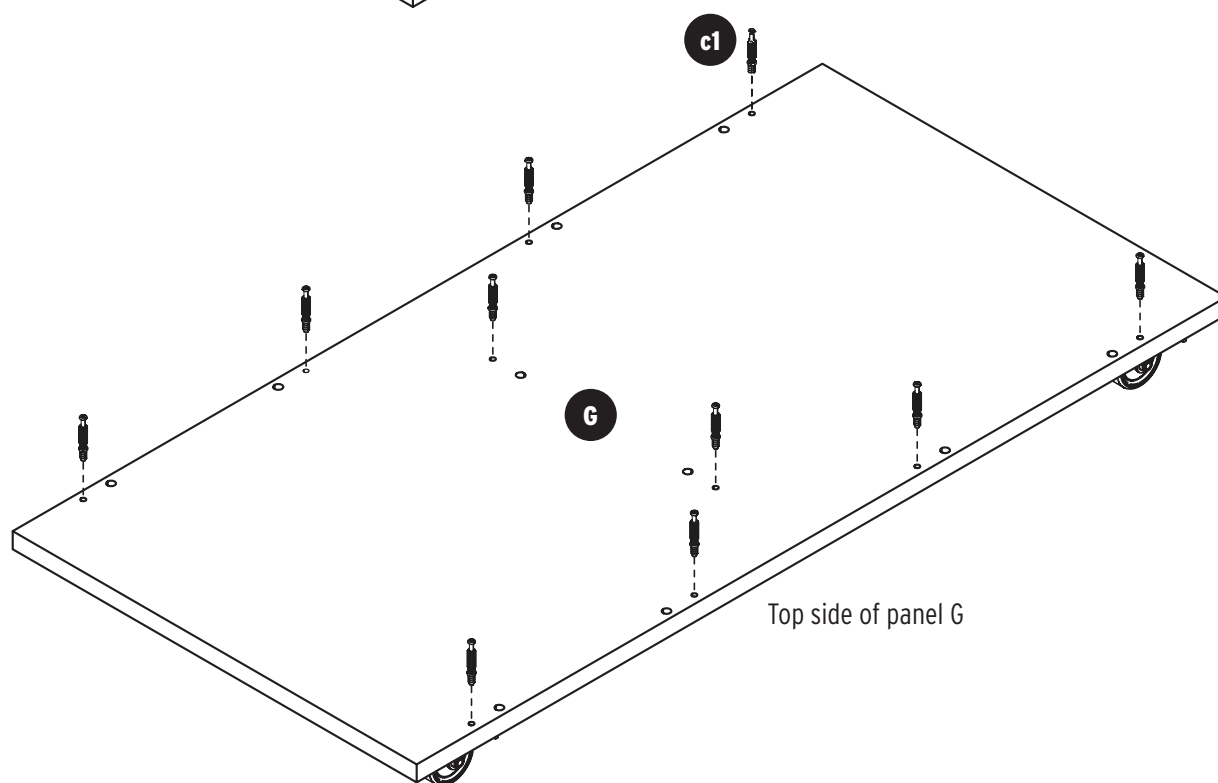
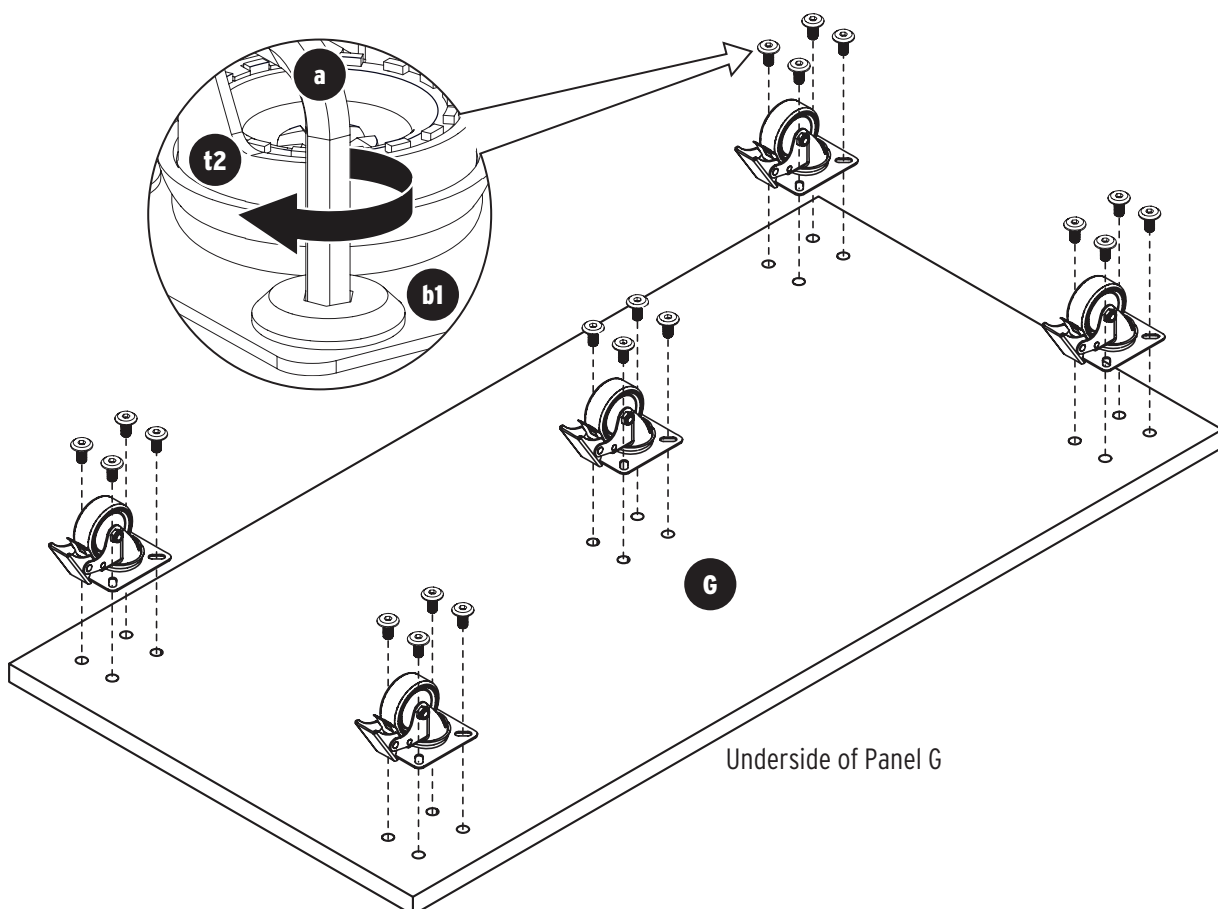

c1
6x35 Cam Bolt **x4****d1**
8x30 Dowel Pin **x16****Step 2. Preparation Panels X and Z**

1. Insert cams bolts **c1** into panels **X** and **Z** as illustrated below.
2. Insert dowel pins **d1** to panels **X** and **Z** as illustrated below.

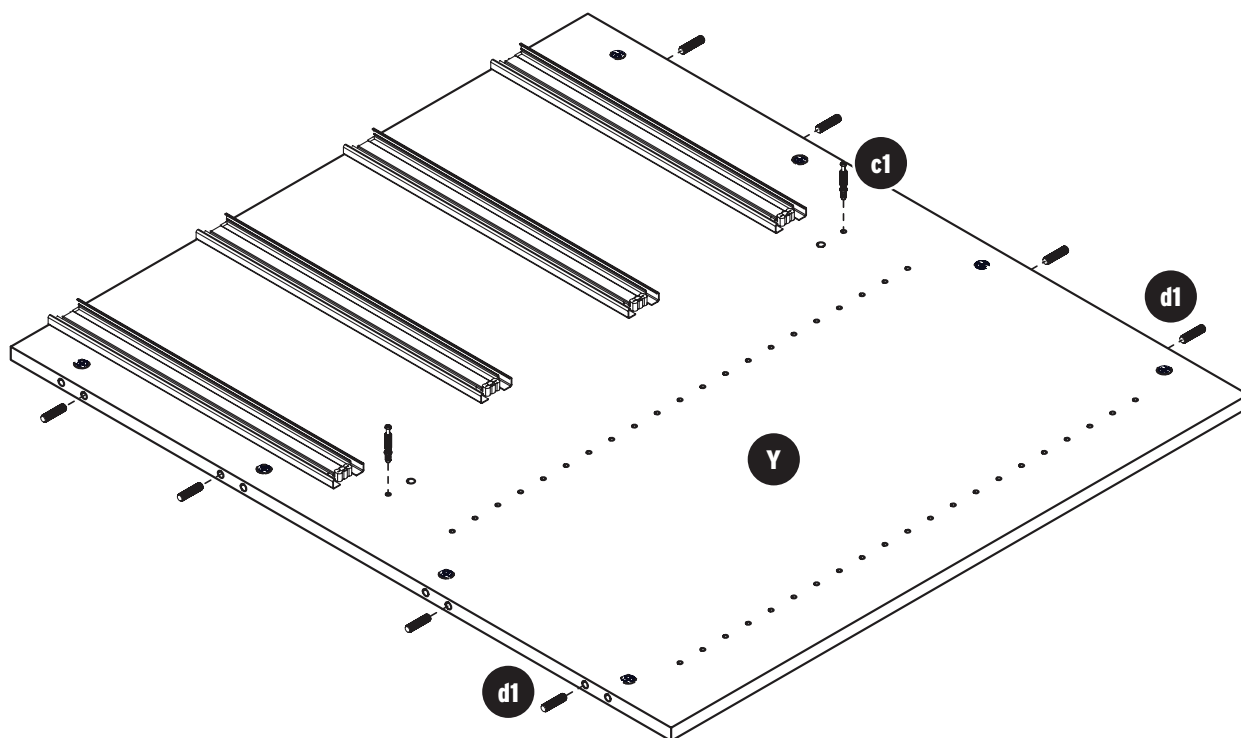
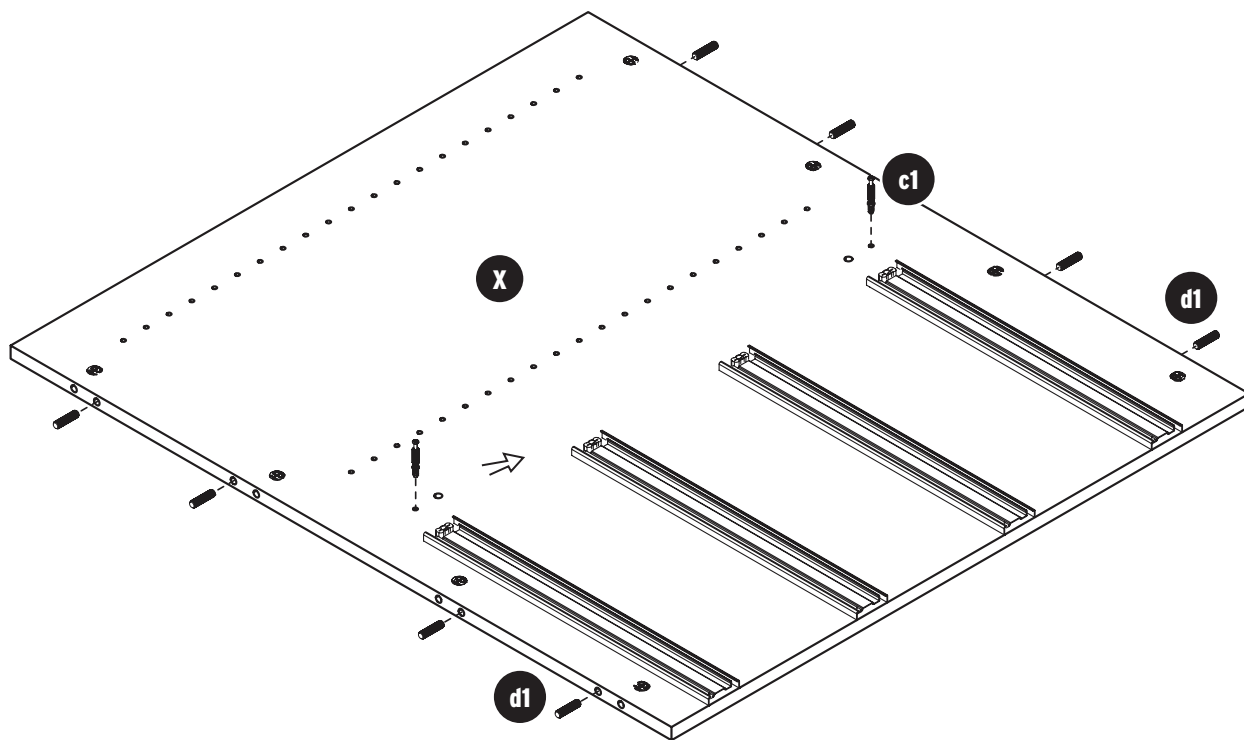

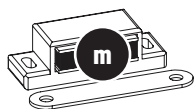
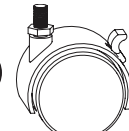
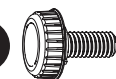
c16x35 Cam Bolt **x10**Magnet **x4**
Catch Plate **x4****h1**Butt Hinge **x14****s1**3.5x14 Screw **x60****s2**3x14 Screw **x8****t1**Caster **x4****r3**14mm Spanner **x1****s5**Alignment Pin **x4****Step 3. Preparation Panels A, A1, 01 and 02**

1. Insert cam bolts **c1** into panels **A** as illustrated below.
2. Locate the pilot holes in panels **A**, **A1**, **01** and **02** and install butt hinges **h1** using **s1** screws.
3. Attach magnet **m** on panels **A1** using **s1** screws.
4. Using spanner **r3** screw caster **t1** into bottom of panels **01** and **02** as shown below.
5. Screw in alignment pin **s4** to panels **01** and **02** as illustrated below.
6. Attach magnet catch plate **m** to panels **01** and **02** using **s2** screws.

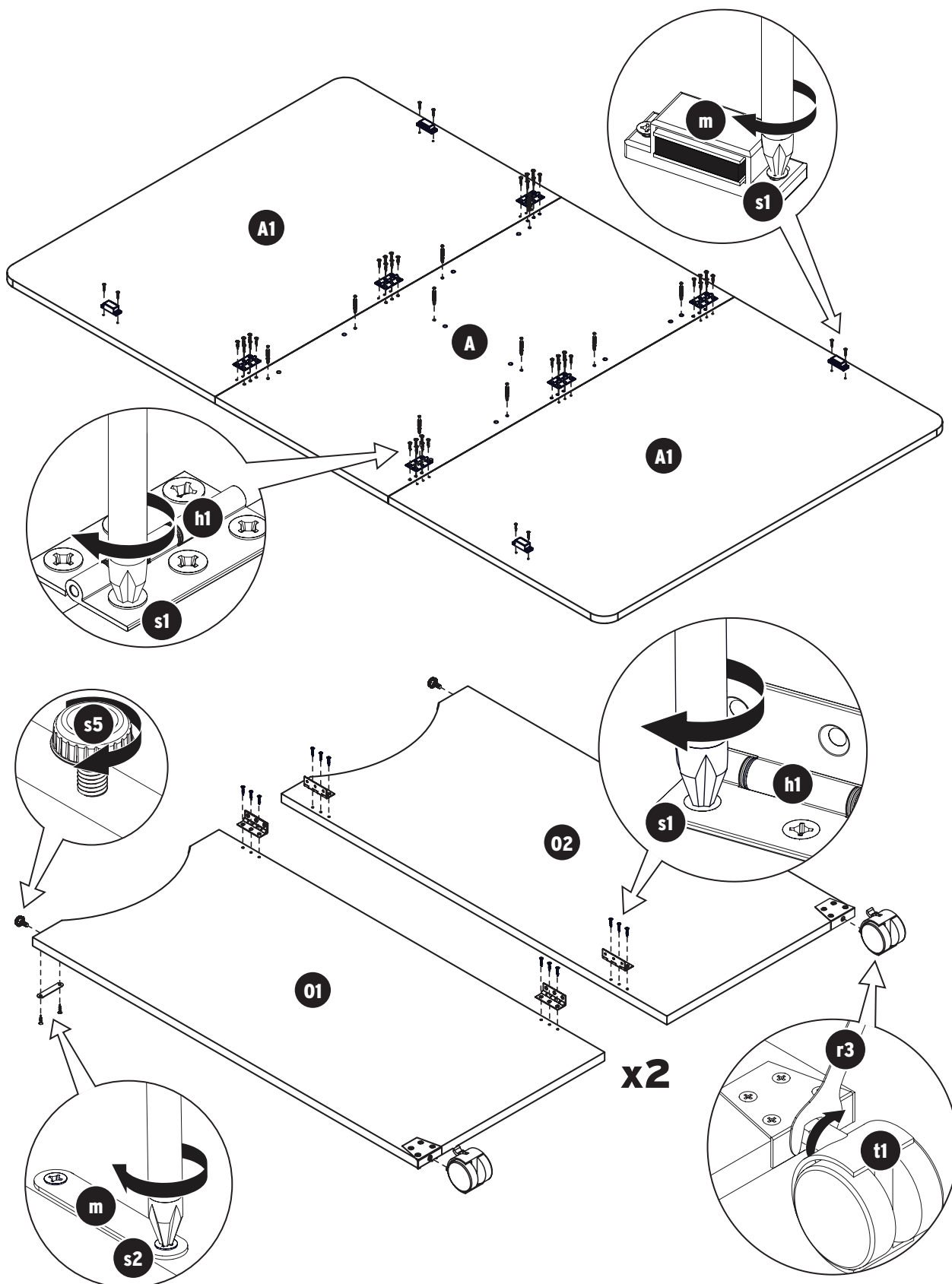

c16x35 Cam Bolt **x16****d1**8x30 Dowel Pin **x16****h**Handle **x4****b2**4x24 Fix Bolt **x8****Step 4. Preparation Panels Y, L, L1 and L2**

1. Insert cam bolts **c1** into panels **L** as illustrated below.
2. Insert dowel pins **d1** to panels **Y**, **L1** and **L2** as illustrated below.
3. Attach handle **h** to panel **L** using screws **b2**.

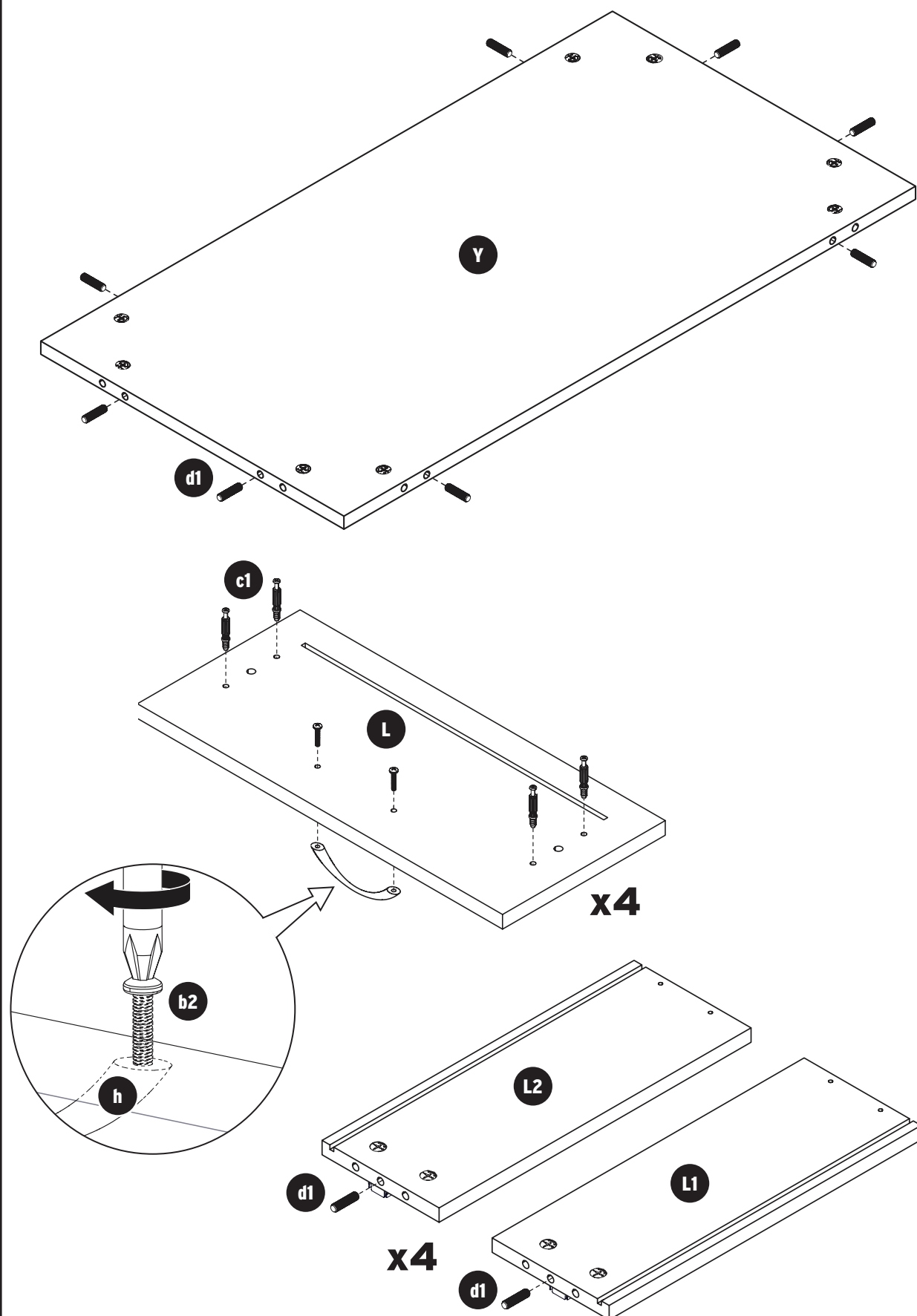

c2 $\frac{5}{8}$ " Cam Cover **x4****Step 5. Panels Y, X, and Z assembly.**

1. Insert cam bolts **c1** on panels **X** and **Z** into cams on panel **Y** and tighten in a clockwise direction as illustrated below.
2. Apply cam covers **c2** over tightened cams.

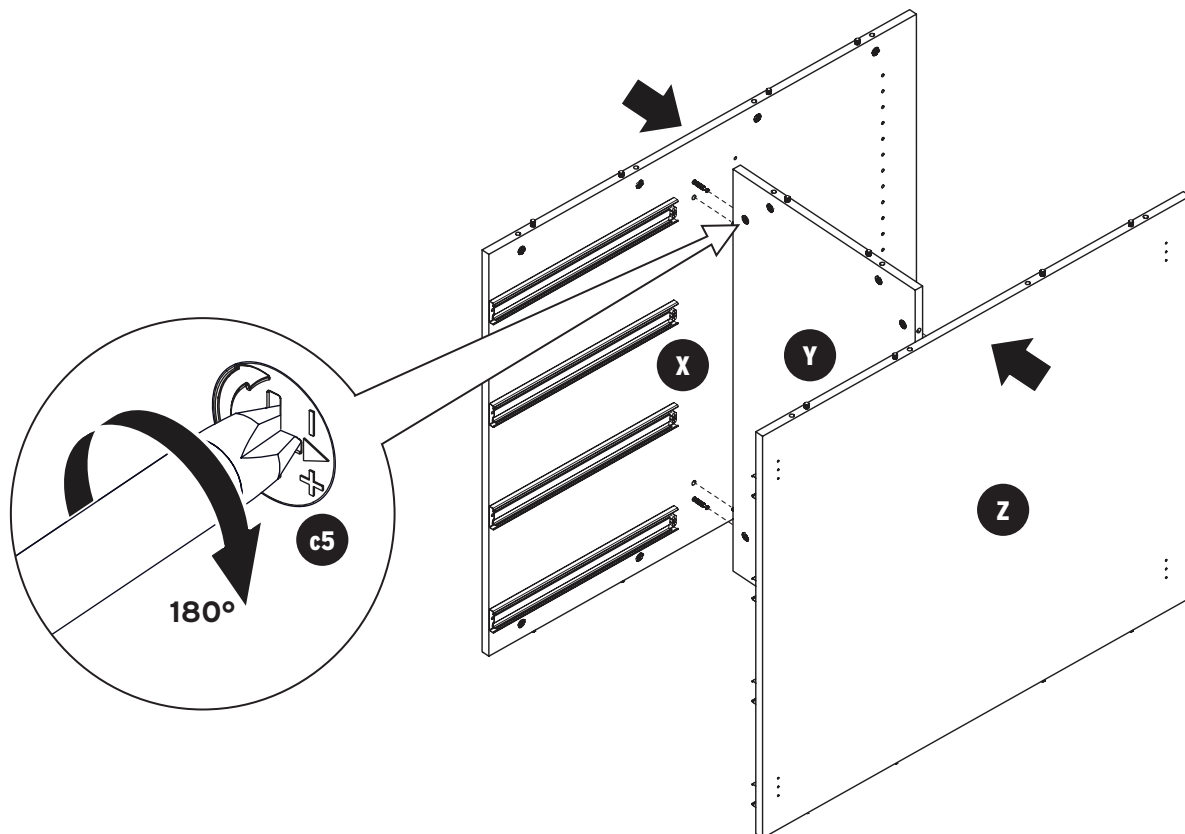
**c2** $\frac{5}{8}$ " Cam Cover **x10****Step 6. Panel G assembly.**

1. Insert cam bolts **c1** on panel **G** into cams on panels **X**, **Y** and **Z** and tighten in a clockwise direction.
2. Apply cam covers **c2** over tightened cams.

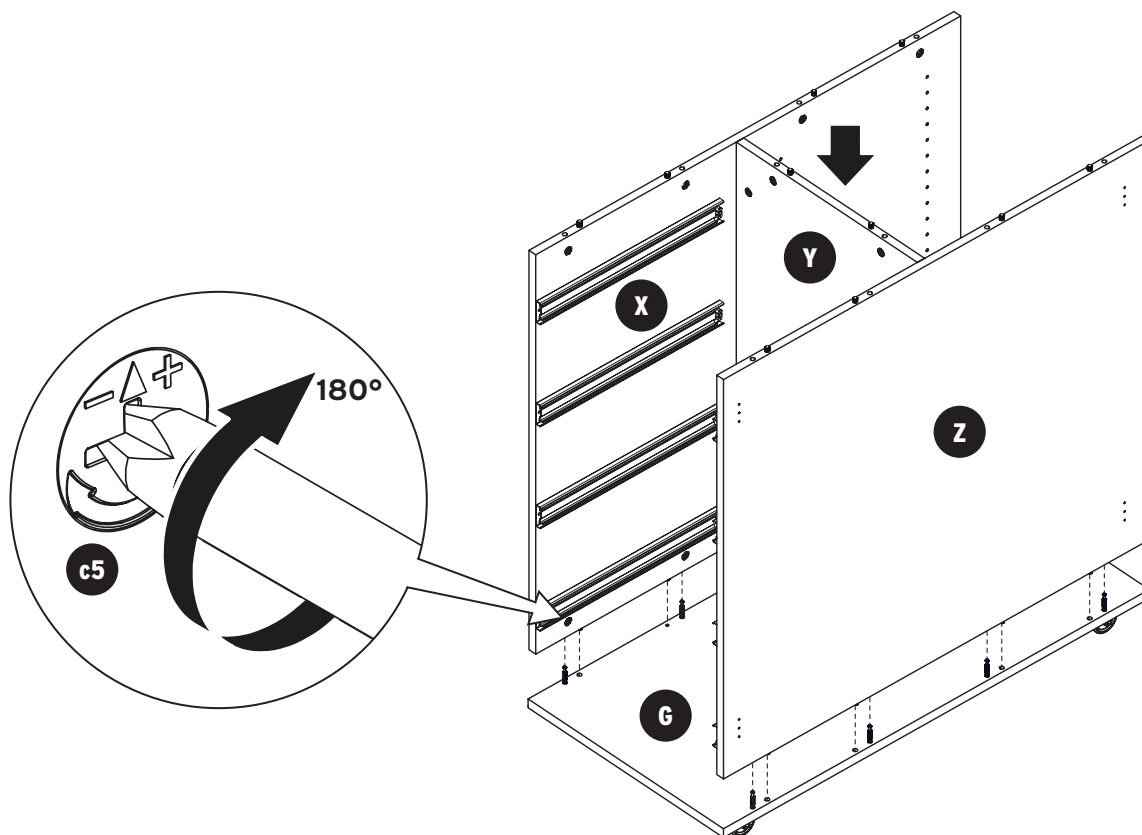

s1 
3.5x14 Screw **x24**

Step 7. Panels 01 and 02 assembly.

1. Locate the pilot holes on side panels **X** and **Z** and attach butt hinges **h1** found on gate leg panels **01** and **02** with 3 **s1** screws per hinge to panels **X** and **Z**.

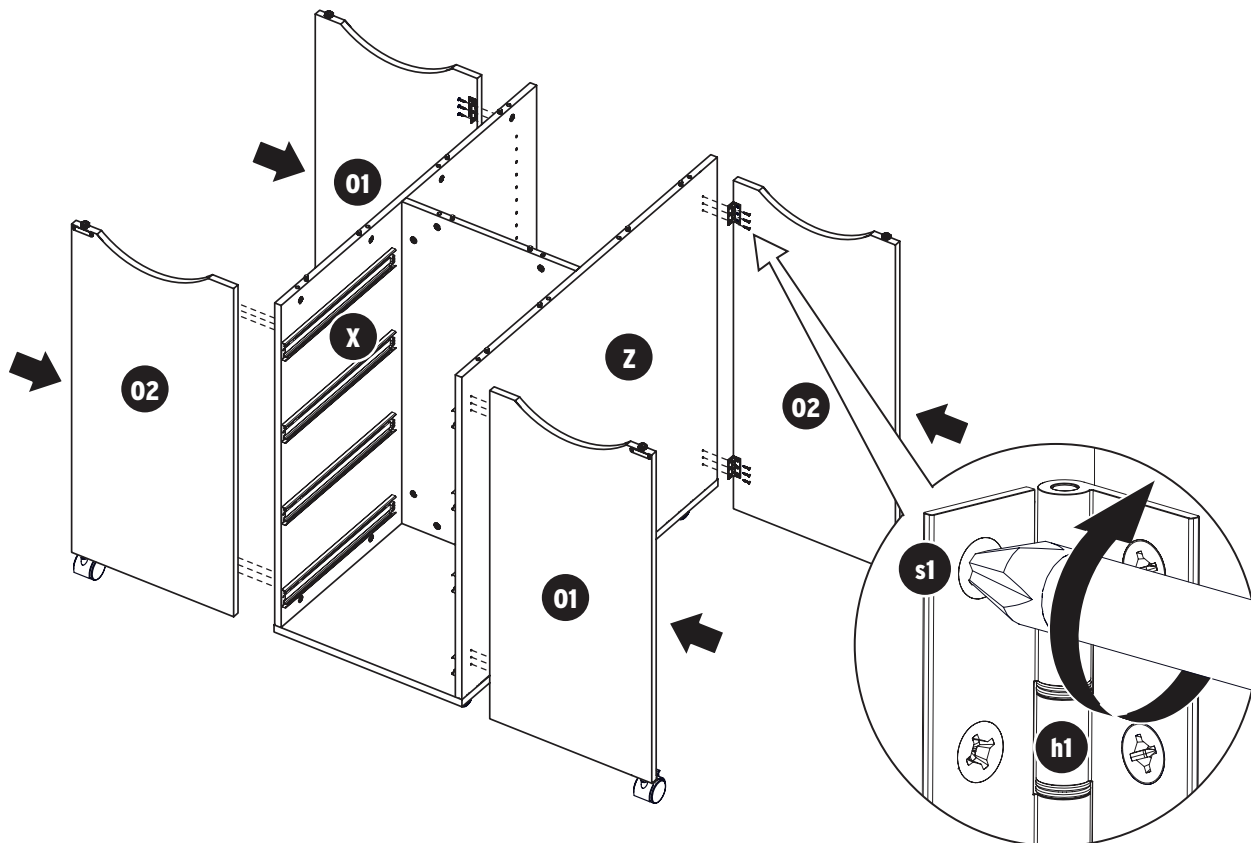

c2 
5/8" Cam Cover **x10**

Step 8. Panels A and A1 assembly.

1. Insert cam bolts **c1** on panel **A** into cams on panels **X**, **Y** and **Z** and tighten in a clockwise direction.
2. Apply cam covers **c2** over tightened cams.

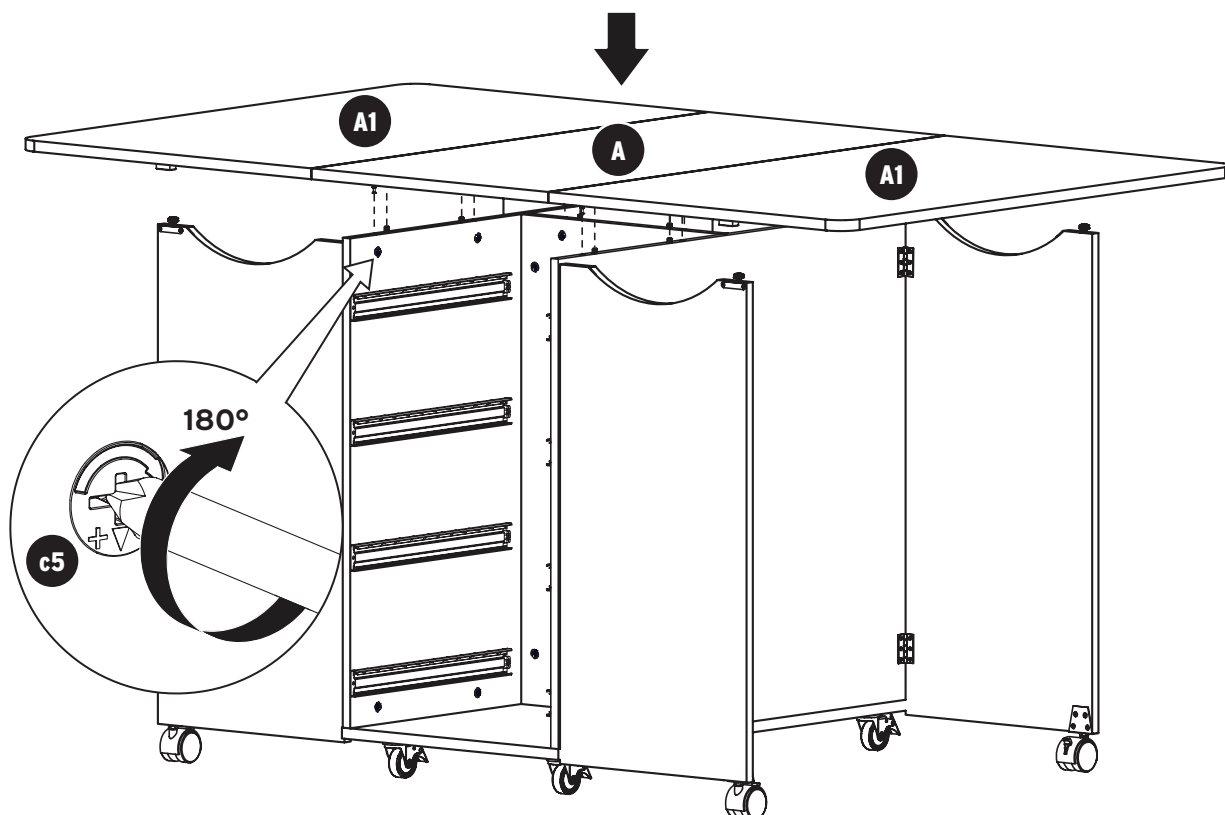

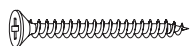
s33.5x30 Screw **x16****c2** $\frac{5}{8}$ " Cam Cover **x16****Step 9. Drawer(s) Panel L, L1, L2, L3 and L4 assembly.**

1. Connect drawer panels **L1**, **L2** and **L3** with screws **s3** as illustrated below. Screws will create the holes in panel **L3** so line up carefully.
2. Slide bottom **L4** into **L**, **L1**, **L2** and **L3** grooves as illustrated.
3. Insert cam bolts **c1** on panel **L** into cam on panels **L1** and **L2**. Tighten cams clockwise.
4. Apply cam covers **c2** over tightened cams.

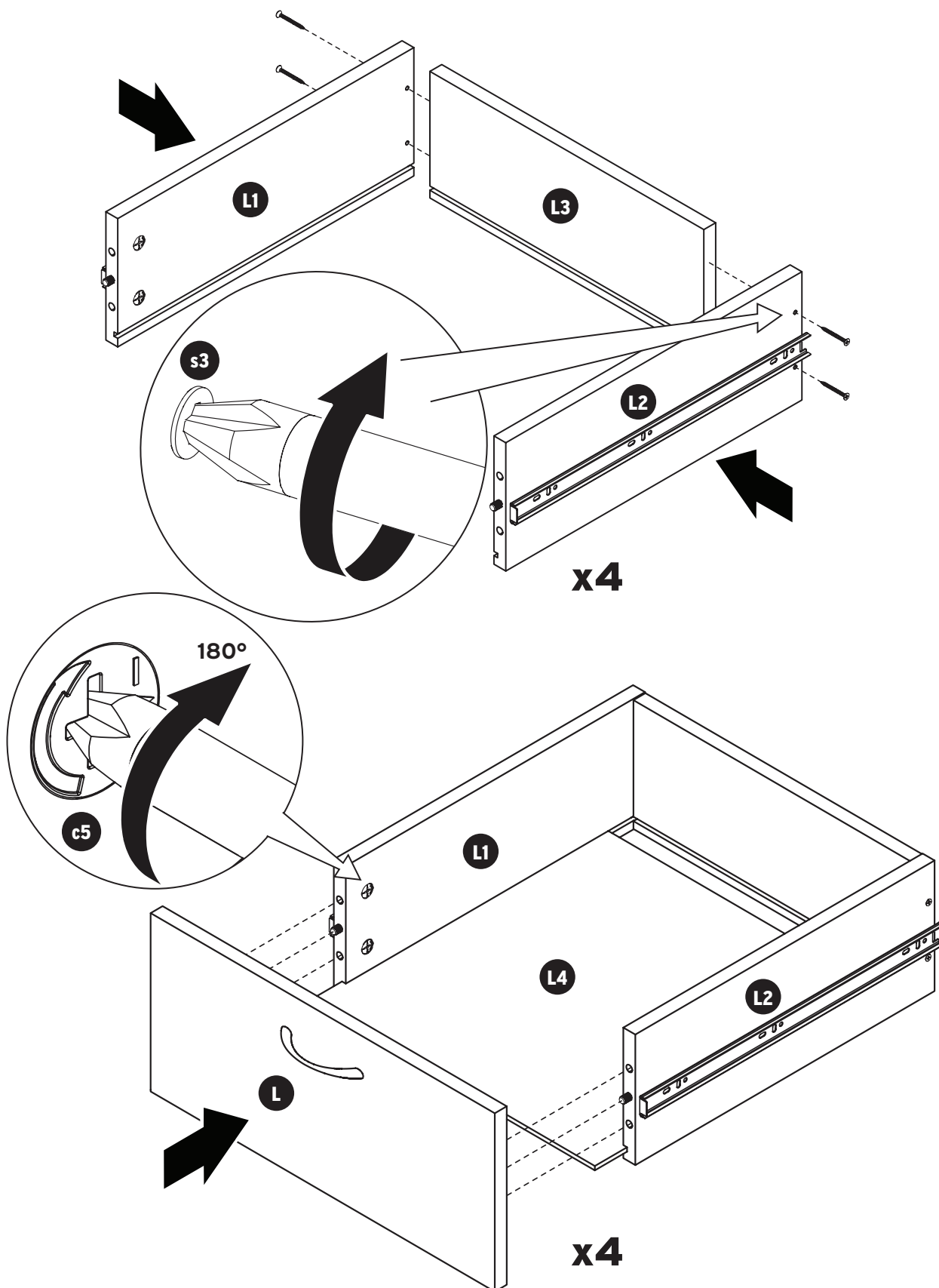

Step 10. Drawers assembly.

Slide drawers into table aligning drawer runners.

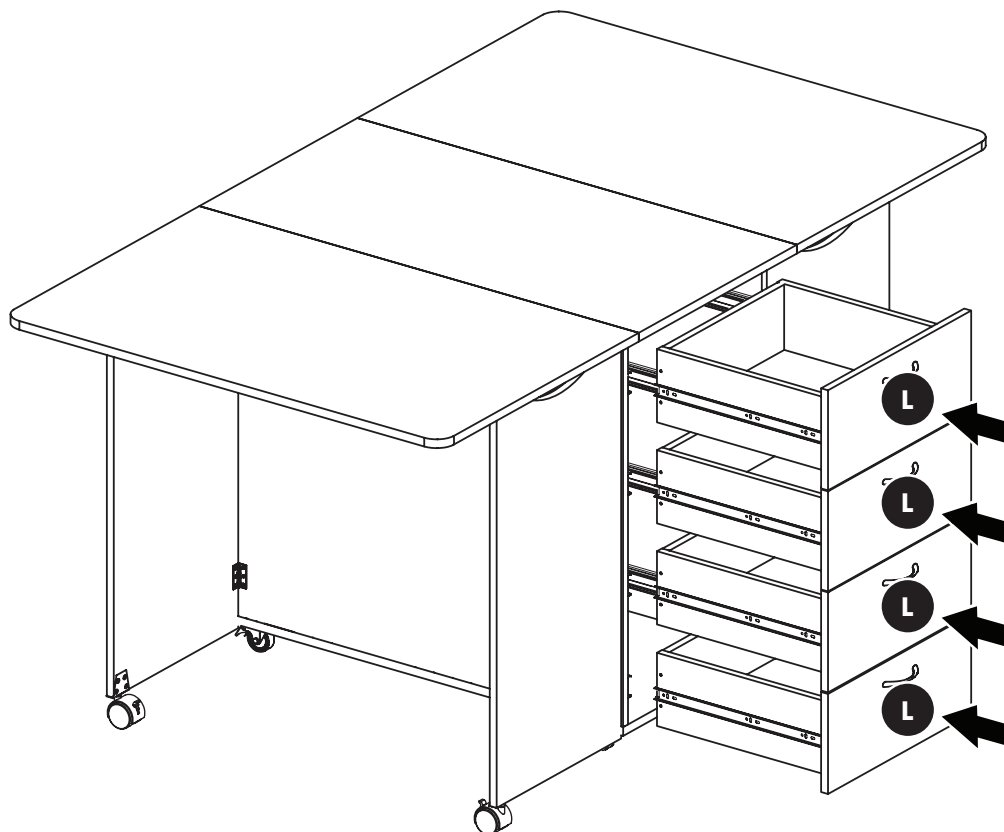

Step 11. Moveable shelf assembly.

1. Press in **p1** pegs with flat surface facing upwards at the same level.
2. Slide shelf **E** with cut in grooves (if available) downwards on top of **p1** pegs.

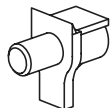

p1 Peg x12

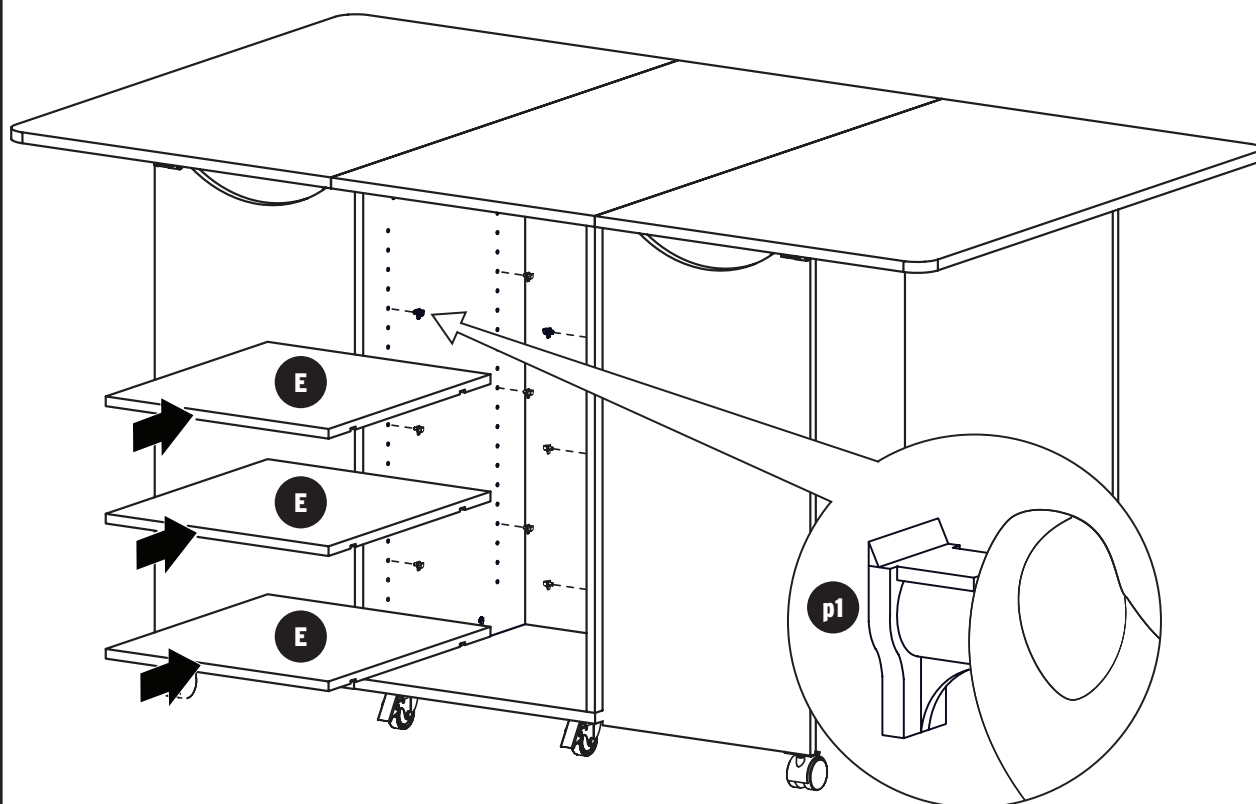

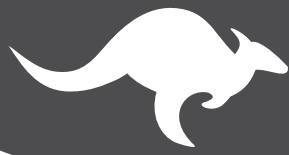

KANGAROO™
sewing furniture

LIMITED LIFETIME WARRANTY

Kangaroo™ Sewing Furniture Limited Lifetime Warranty

WHAT THIS WARRANTY COVERS: Arrow Companies, LLC (Arrow) provides a Limited Lifetime Warranty (warranty) to the original purchaser of this product against defects in materials or workmanship of furniture components. As used in this Warranty, "defect" means imperfections in components which substantially impair the utility of the product. This Warranty gives you specific legal rights, and you may also have other rights which vary from state to state. Electrical and mechanical components of furniture are warranted for 5 years.

HOW TO GET SERVICE: Simply contact Arrow at 1-800-533-7347 or CS@ArrowCabinets.com. When you request warranty service, you must also present proof of purchase documentation, which includes the date of purchase (detailed receipt), and photos of the product. Arrow will replace any defective part (at its sole option), excluding labor. Replacement parts will be warranted for only the remaining period of the original Warranty.

Replacement parts will be shipped freight prepaid on any initial warranty claim during first year of Warranty only. Warranty applies only to defects confirmed by Arrow Companies, LLC and will be replaced or repaired at Arrow's option. In the event parts are no longer available for a warranty claim, customer may receive brand new cabinet at a price equal to 60% off the MSRP of a current comparable model.

WHAT'S NOT COVERED: There is no warranty coverage for defects or conditions that result from the failure to follow product assembly instructions, information or warnings, misuse or abuse, intentional damage, fire, flood, alteration or modification of the product, or use of the product in a manner inconsistent with its intended use, nor any condition resulting from incorrect or inadequate maintenance, cleaning, or care, or neglect, cuts or scratches. Caster damage as a result of moving furniture fully loaded or with locked casters. Damage resulting from electrical surge or lightning. Use in commercial or education environments. Kangaroo Sewing Furniture is designed for residential use only.

ARROW SHALL HAVE NO LIABILITY for ANY INCIDENTAL OR CONSEQUENTIAL DAMAGES OF ANY KIND and all such damages are EXCLUDED FROM THIS WARRANTY, such as loss of use, disassembly, transportation, labor or damage to property on or near the product. Some states do not allow the exclusion or limitation of incidental or consequential damages, so the above limitation or exclusion may not apply to you. The Warranty cannot be transferred to subsequent owners or users of the product, and it shall be immediately void in the event the product is resold, transferred, leased or rented to any third party or person other than the original purchaser.

ADDITIONAL LIMITATIONS:

THERE ARE NO OTHER WARRANTIES APPLICABLE TO THIS PRODUCT. Under the laws of certain states, there may be no implied warranties from Arrow and all implied warranties, INCLUDING ANY IMPLIED WARRANTY OF MERCHANTABILITY OR FITNESS FOR A PARTICULAR PURPOSE are disclaimed where allowed by law. TO THE EXTENT ANY IMPLIED WARRANTIES ARE APPLICABLE, ANY IMPLIED WARRANTIES, INCLUDING ANY IMPLIED WARRANTY OF MERCHANTABILITY OR FITNESS FOR A PARTICULAR PURPOSE, ARE LIMITED IN DURATION TO THE DURATION OF THIS EXPRESS WARRANTY or the minimum period allowed by law, whichever is shorter. Some states do not allow limitations on how long an implied Warranty lasts, so the above limitation may not apply to you. This limited warranty gives you specific legal rights. This limited warranty does not, in any way, affect the rights given to you by law.

REGISTER YOUR PRODUCT: Original purchaser should register the purchase online at www.ArrowCabinets.com/warranty.

SEW IN COMFORT. SEW LONGER.™

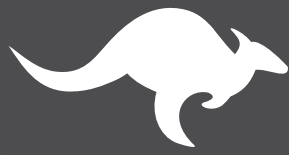

KANGAROO™

sewing furniture

Accessories to Complete Your Sewing Experience

Custom Insert

Enhance your sewing experience with a custom-made insert for your Arrow or Kangaroo cabinet. Inserts are designed to reduce the gap between the machine and cabinet opening. This provides an ergonomic work surface for the free arm of the sewing machine, allowing for straighter stitches, less fatigue and an overall better experience using your machine and cabinet.

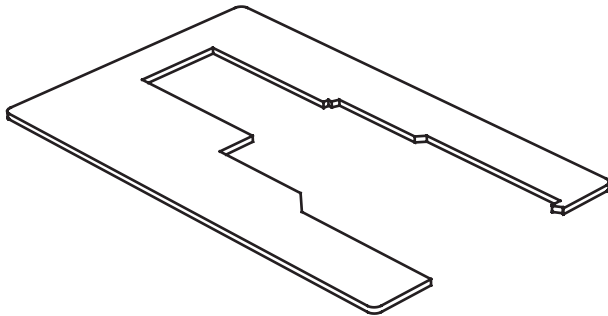

Insert

Arrow Sewing Chairs

Our adjustable height sewing chair is a perfect accessory for any craft and sewing room. The chair's height is adjustable with easy to use controls and the cushions provide perfect lumbar support and comfort for those long sewing hours. Chair features five casters on a star base for greater movement at your sewing cabinet or crafting surface. Lift the seat cushion to reveal a hidden storage compartment for your small notions or patterns.

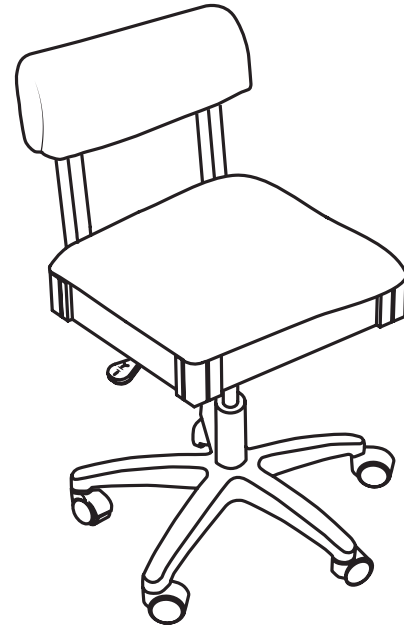

Hydraulic Sewing Chair

PO Box 410, Elkhorn, WI 53121
1-800-533-7347 Ext. 1
CS@ArrowCabinets.com
www.ArrowCabinets.com

08-20