



DIXIE

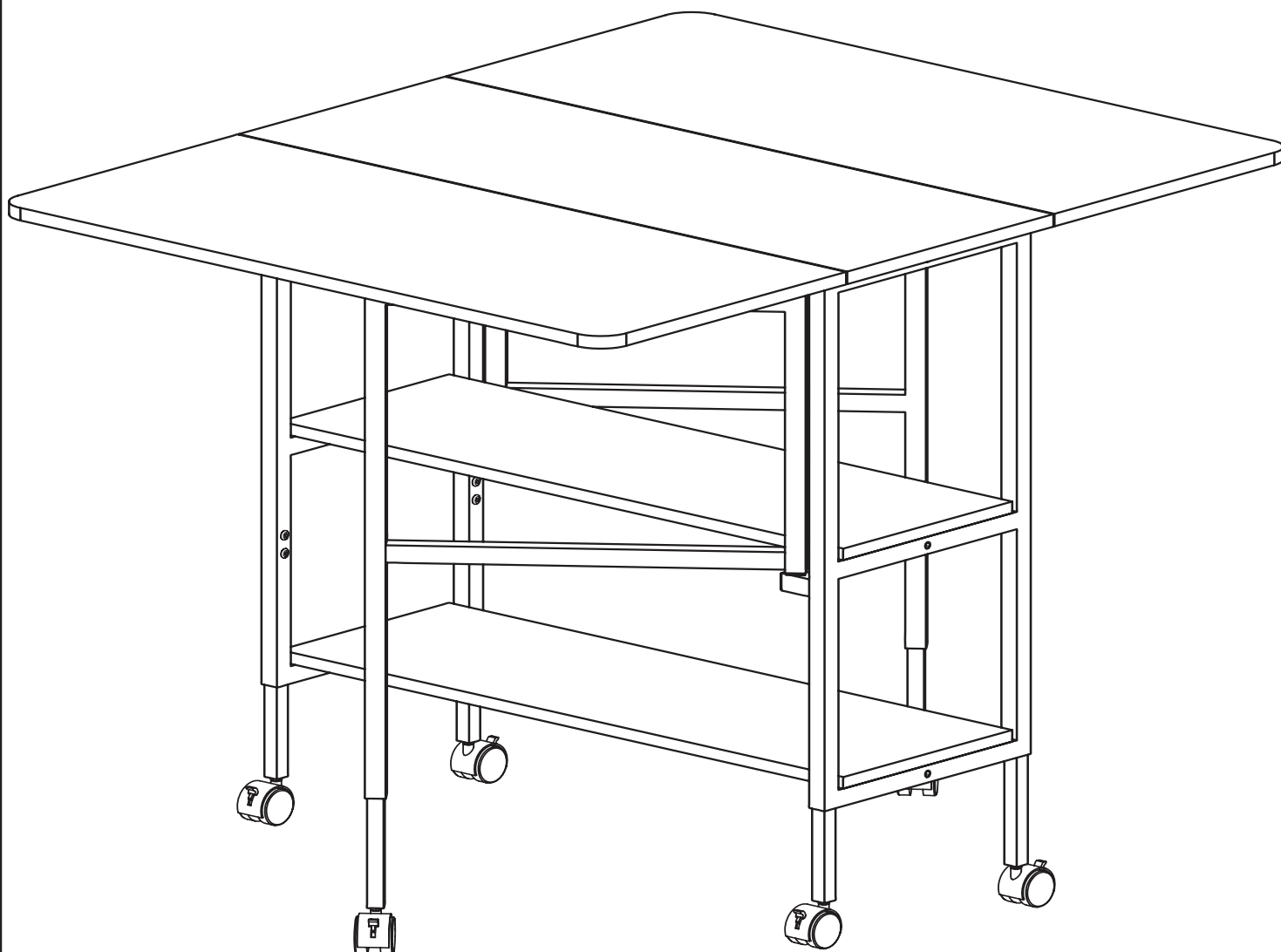
CUTTING TABLE

OWNER'S MANUAL

Assembly Instructions

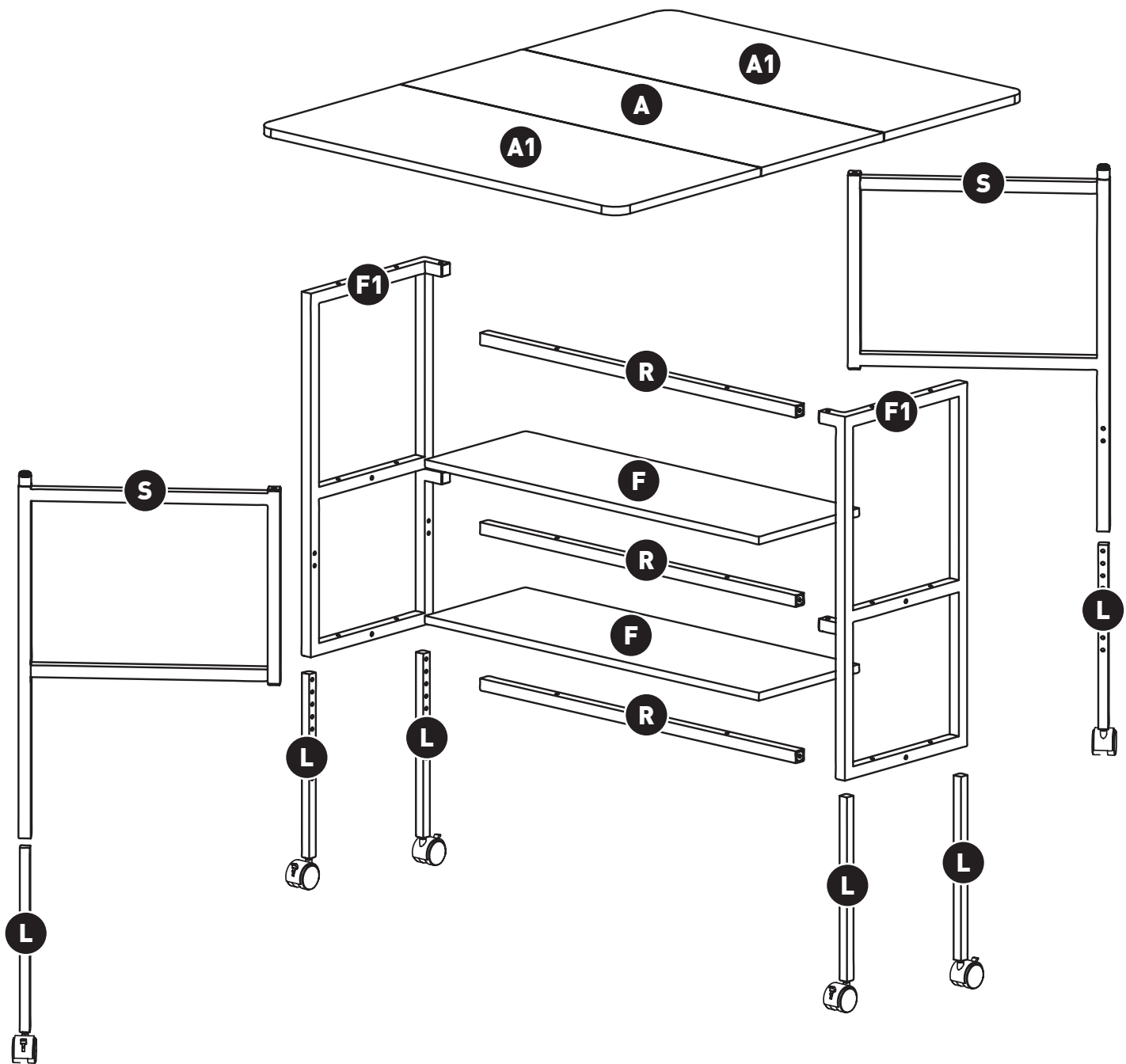
Model Numbers:

3401 | White



IMPORTANT: Please read these instructions before assembling!

Parts List



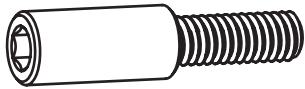
ITEM	DESCRIPTION	QTY.	PACK.
A	Top panel	1	2 of 2
A1	Top leaf	2	2 of 2
F	Fixed shelf	2	2 of 2
F1	Frame leg support	2	1 of 2
S	Side leg supports	2	1 of 2
L	Adjustable leg with casters	6	1 of 2
R	Rail	3	1 of 2

Hardware Included

ITEM	DESCRIPTION	QTY.
b1	6x12 Bolt	12
b2	8x25 Bolt	10
b3	4x8 Bolt	2
b4	6x35 Bolt	18
B	Bracket	2
p	Plastic Support Tube	2
h1	Hinge	6
r1	4mm Allen key	1
r2	5mm Allen key	1
r3	14mm Spanner	1
s1	3.5x14 Screw	42
t	Caster	6



b1 6x12 Bolt x12



b2 8x25 Bolt x10



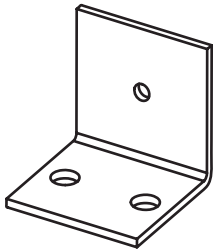
b3 4x8 Bolt x2



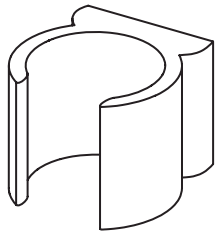
b4 6x35 Bolt x18



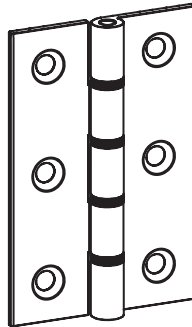
s1 3.5x14 Screw x42



b Bracket x2



p Plastic Support Tube x2



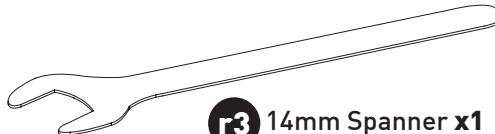
h1 Hinge x6



r1 4mm Allen key x12

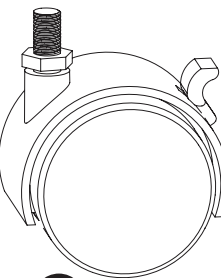


r2 5mm Allen key x1



r3 14mm Spanner x1

Pre-installed parts



t Caster

Tools required

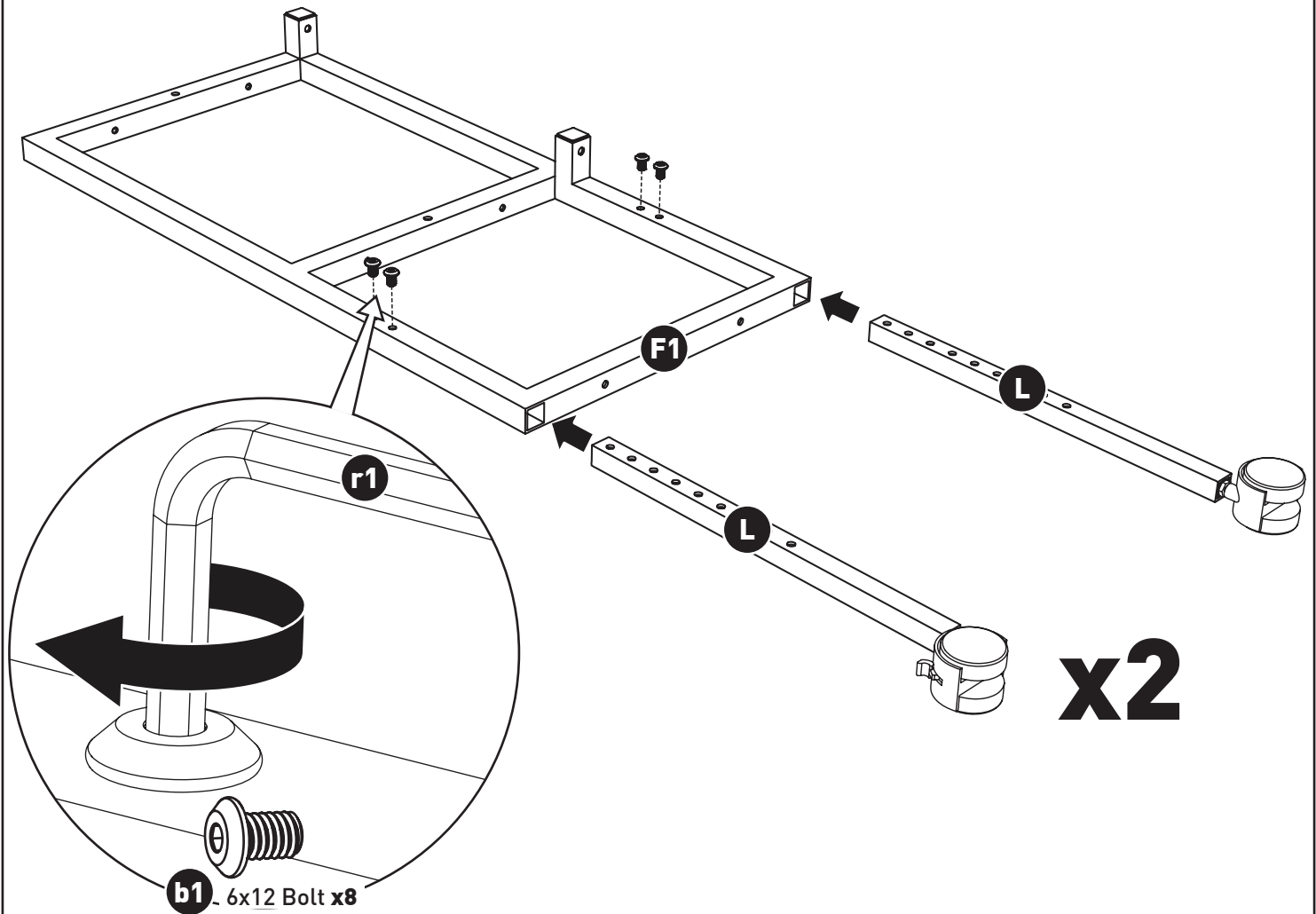


Phillips Screwdriver

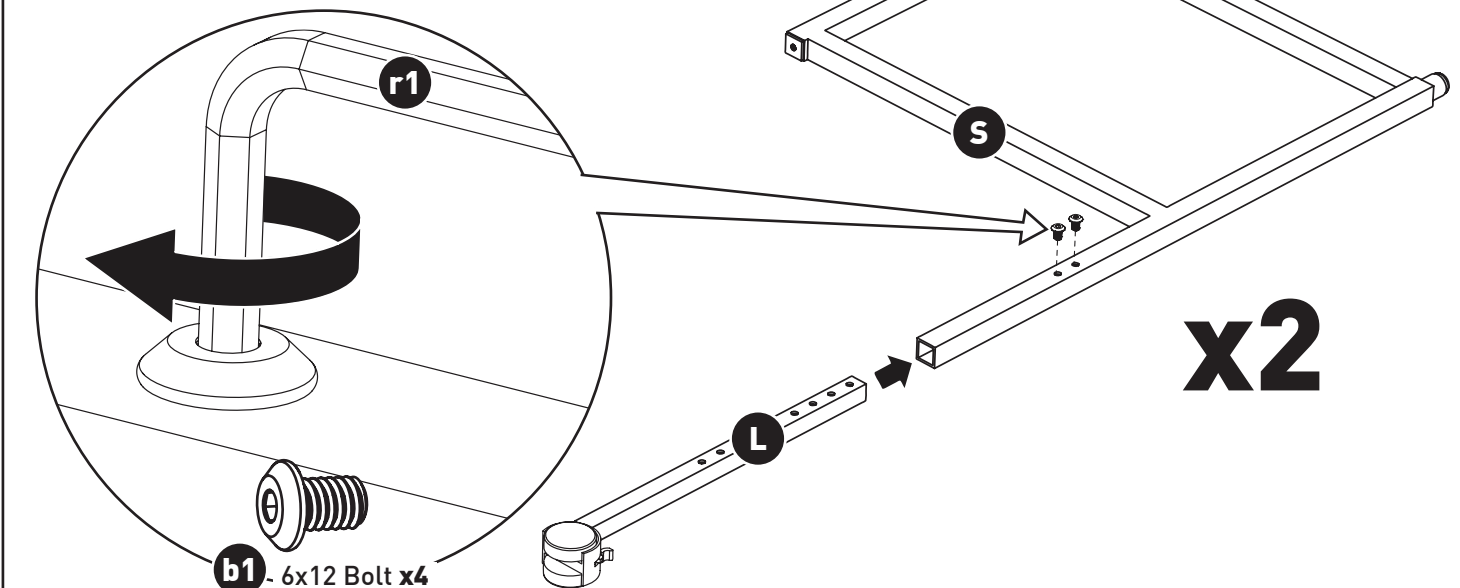


Table Assembly

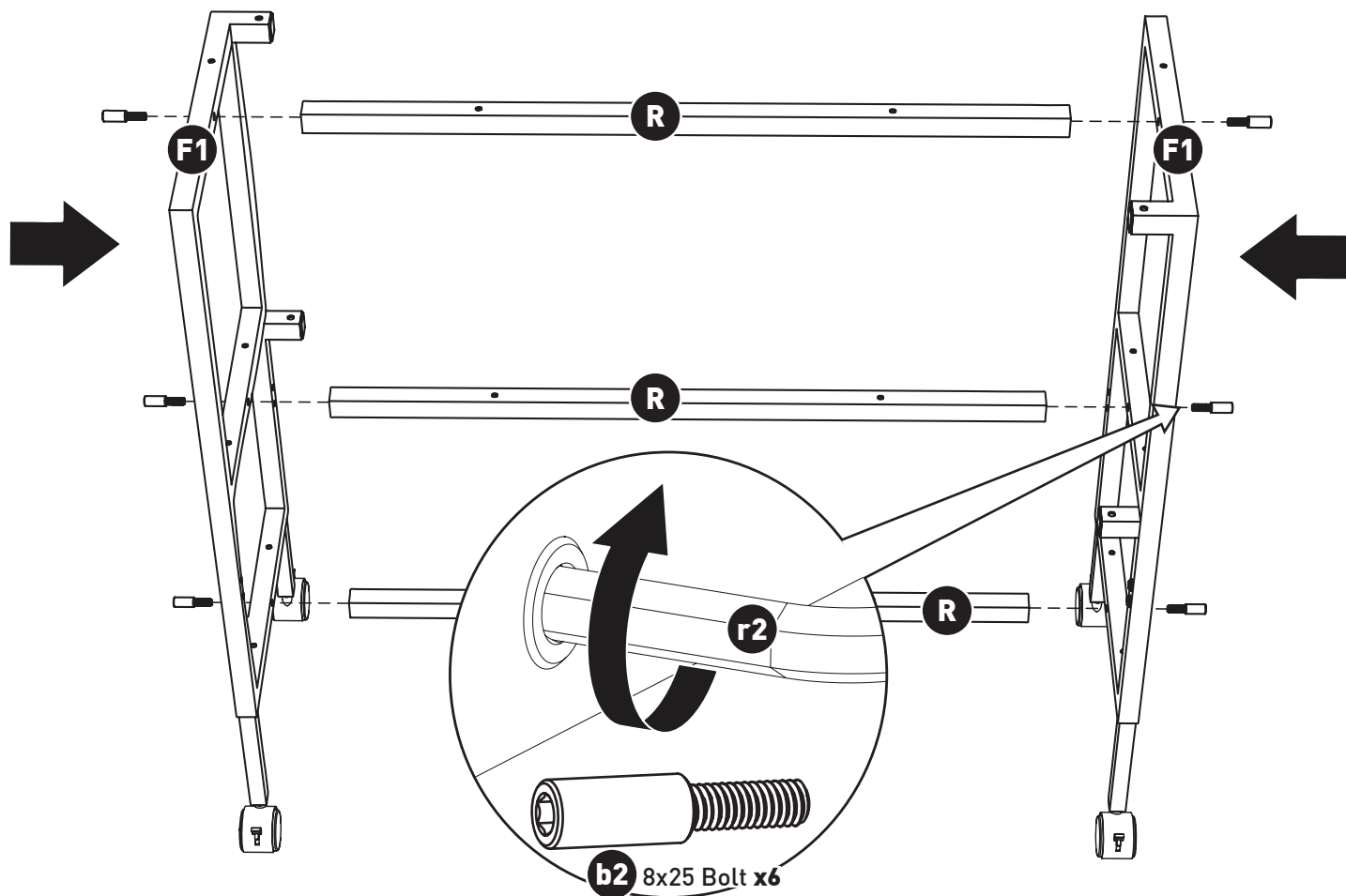
Step 1. Slide in adjustable legs (L) into frame legs support (F1) to desired height and lock using bolts (b1) with (r1) Allen key spanner as shown on the illustration below.



Step 2. Slide in adjustable legs (L) into side legs support (S) to desired height and lock using bolts (b1) with (r1) Allen key spanner as shown on the illustration below.

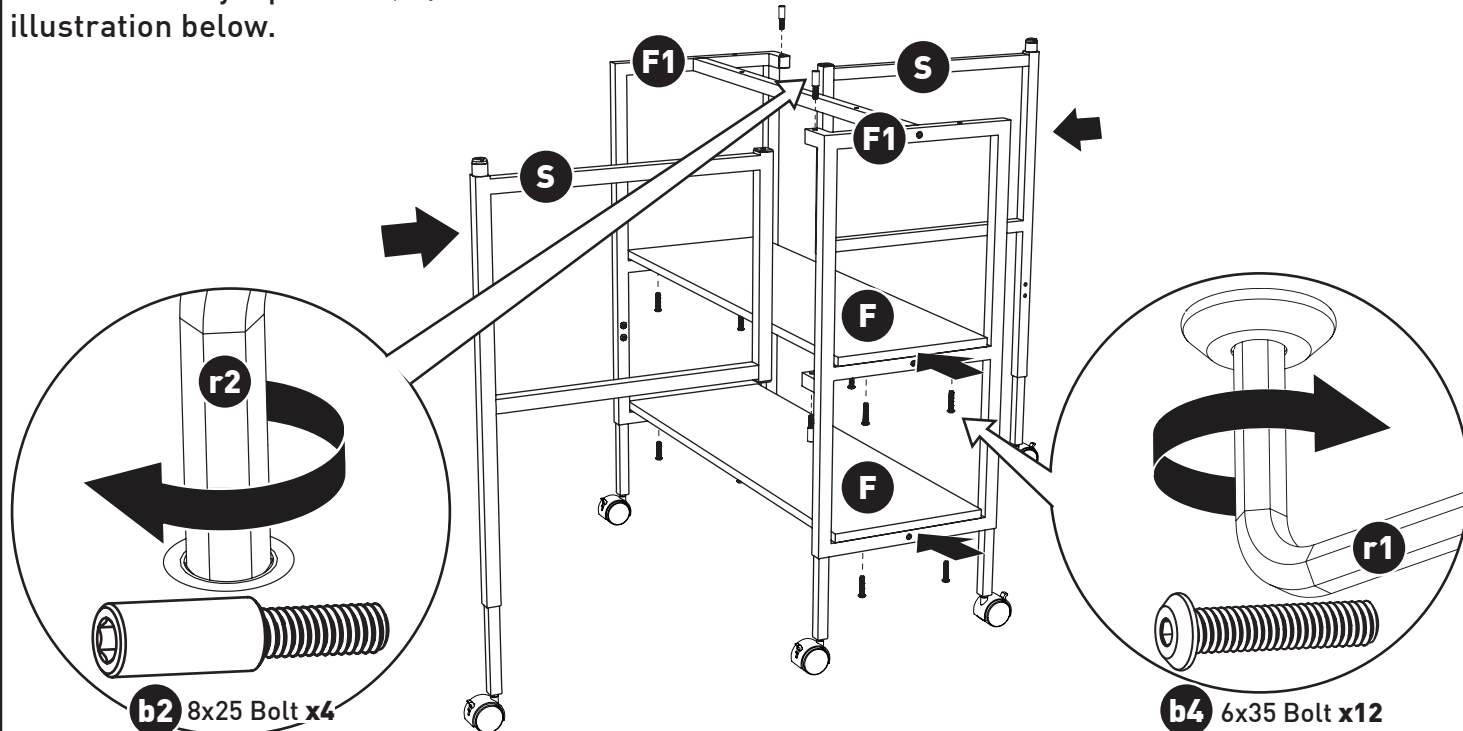


Step 3. Connect the two frame leg supports (F1) with three rails (R) using bolts (b2) using Allen key spanner (r2) as shown on the illustration below.

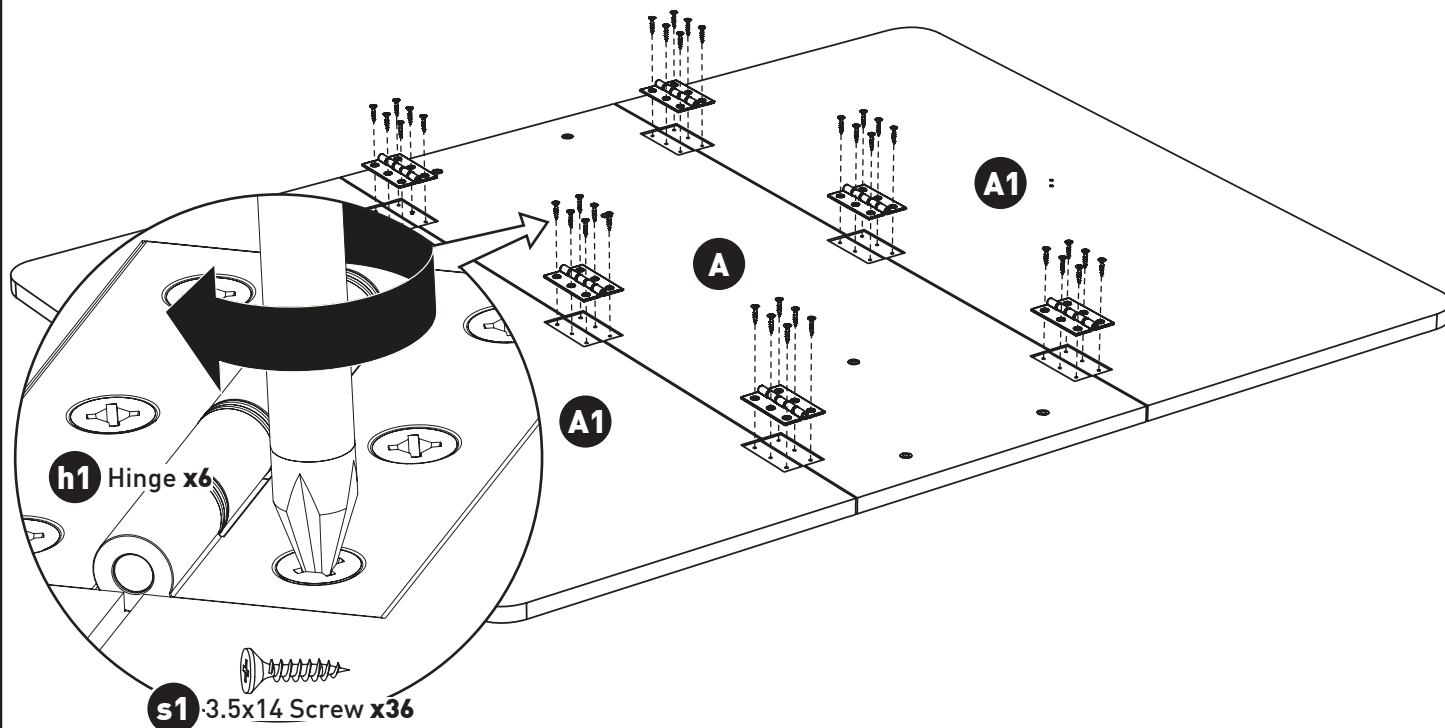


Step 4. Connect the two side leg supports (S) with leg frame assembly (F1) using bolts (b2) with Allen key spanner (r2) as shown on the illustration below.

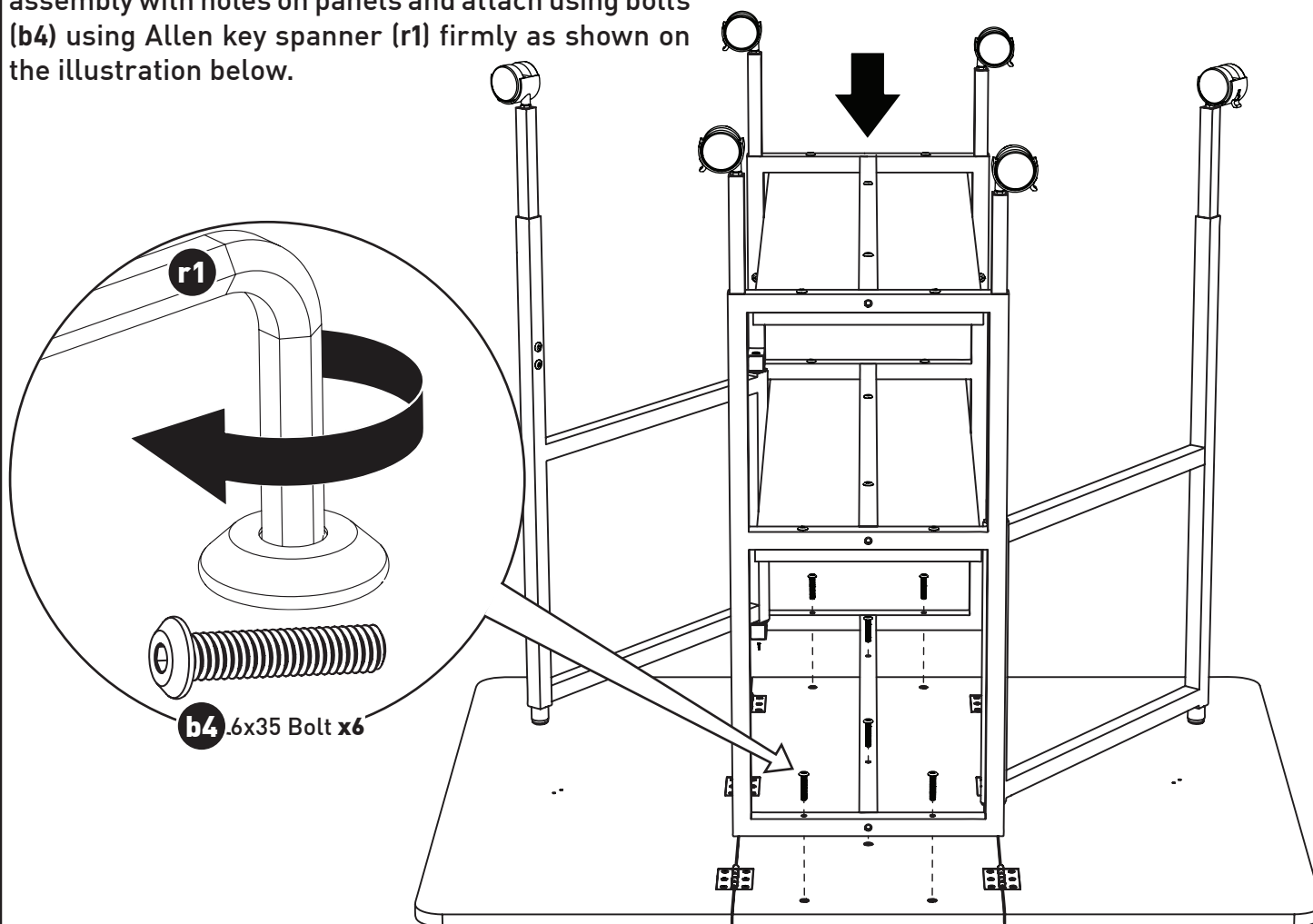
Place the Fixed shelf (F) on the place and attach using bolts (b4) using Allen key spanner (r1) firmly as shown on the illustration below.



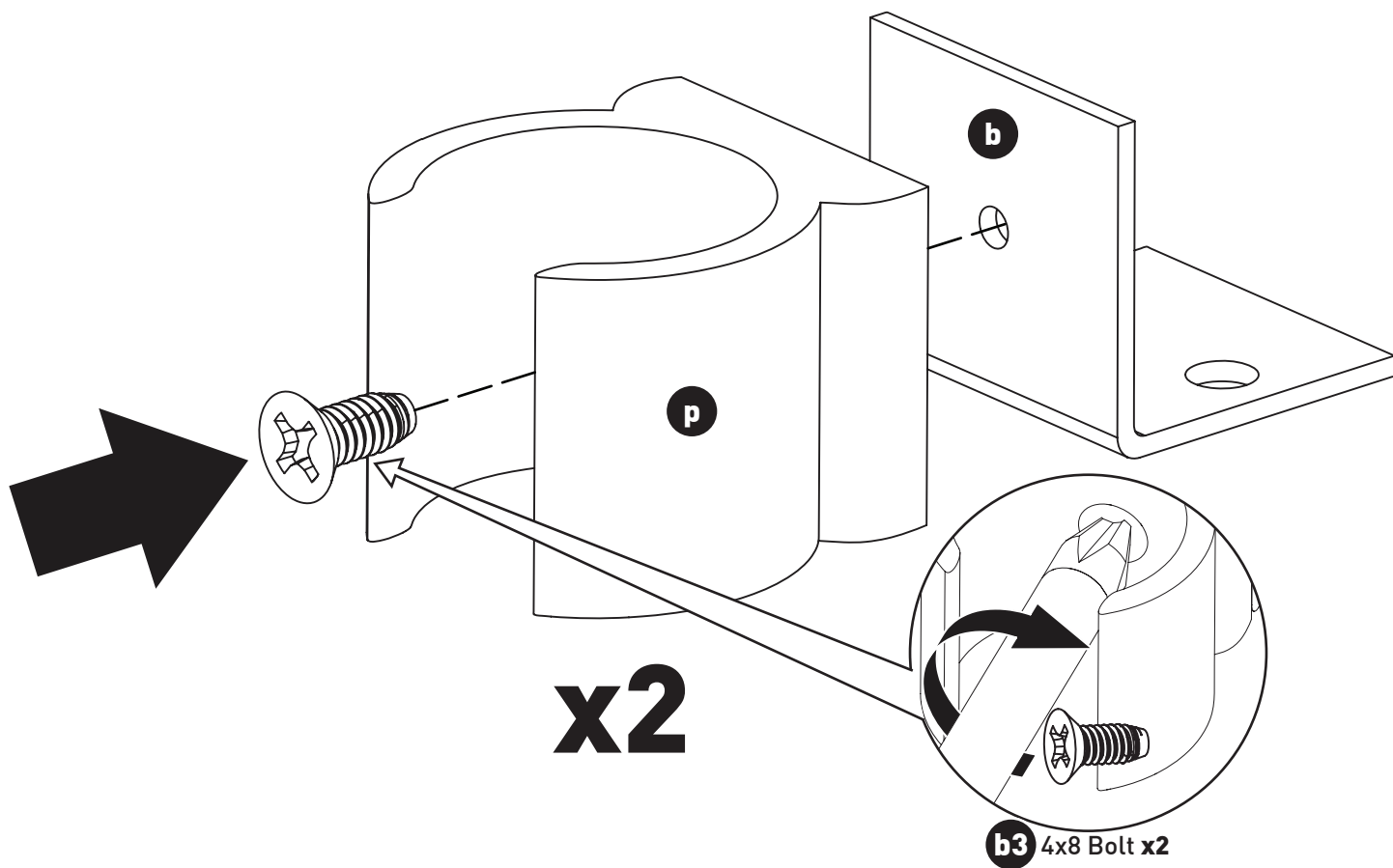
Step 5. Lay panels (A1), (A) on a clean soft surface. Attach hinges (h1) with screws (s1) following the predrilled holes as shown on the illustration below.



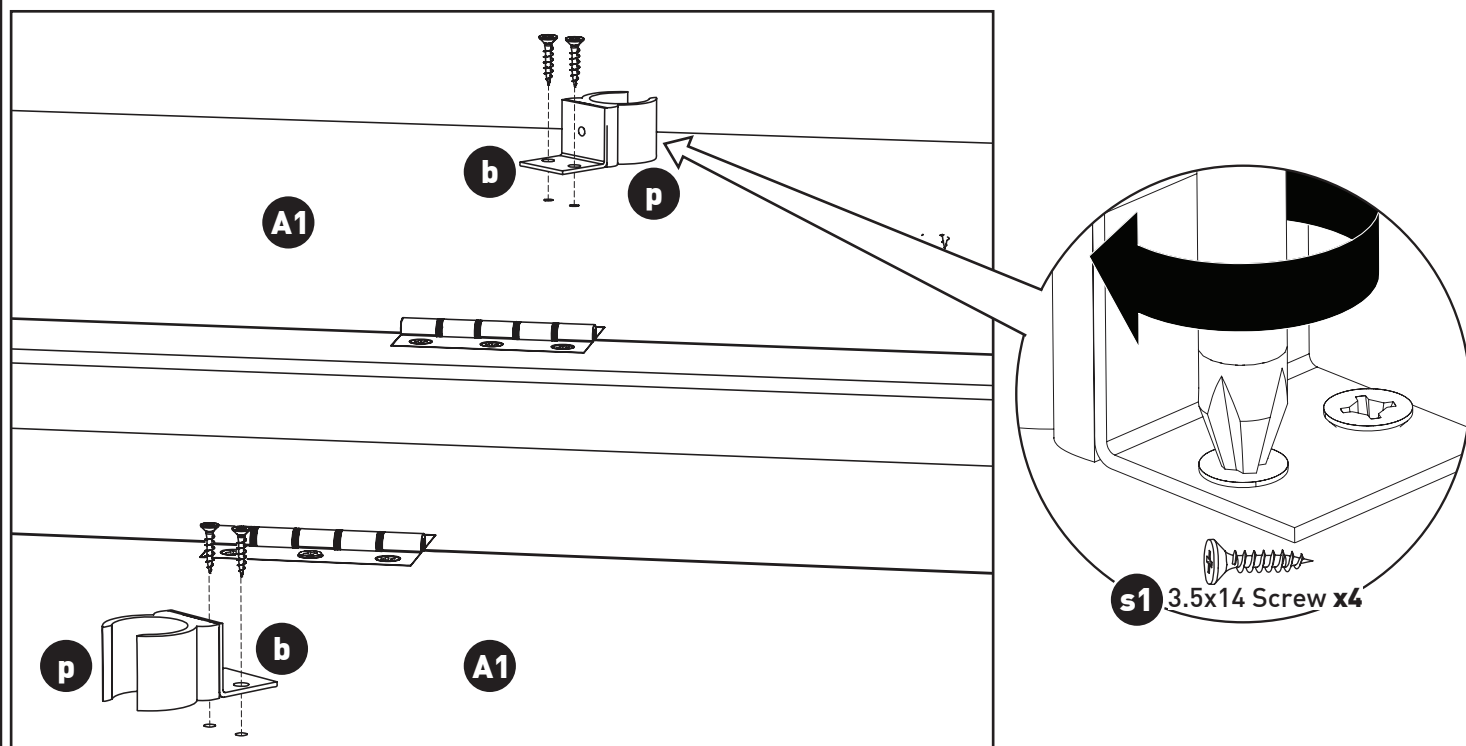
Step 6. Two people should flip and align entire leg assembly with holes on panels and attach using bolts (b4) using Allen key spanner (r1) firmly as shown on the illustration below.



Step 7. Attach plastic support tube (p) with connector (b) using bolt (b3) firmly as shown on the illustration below.

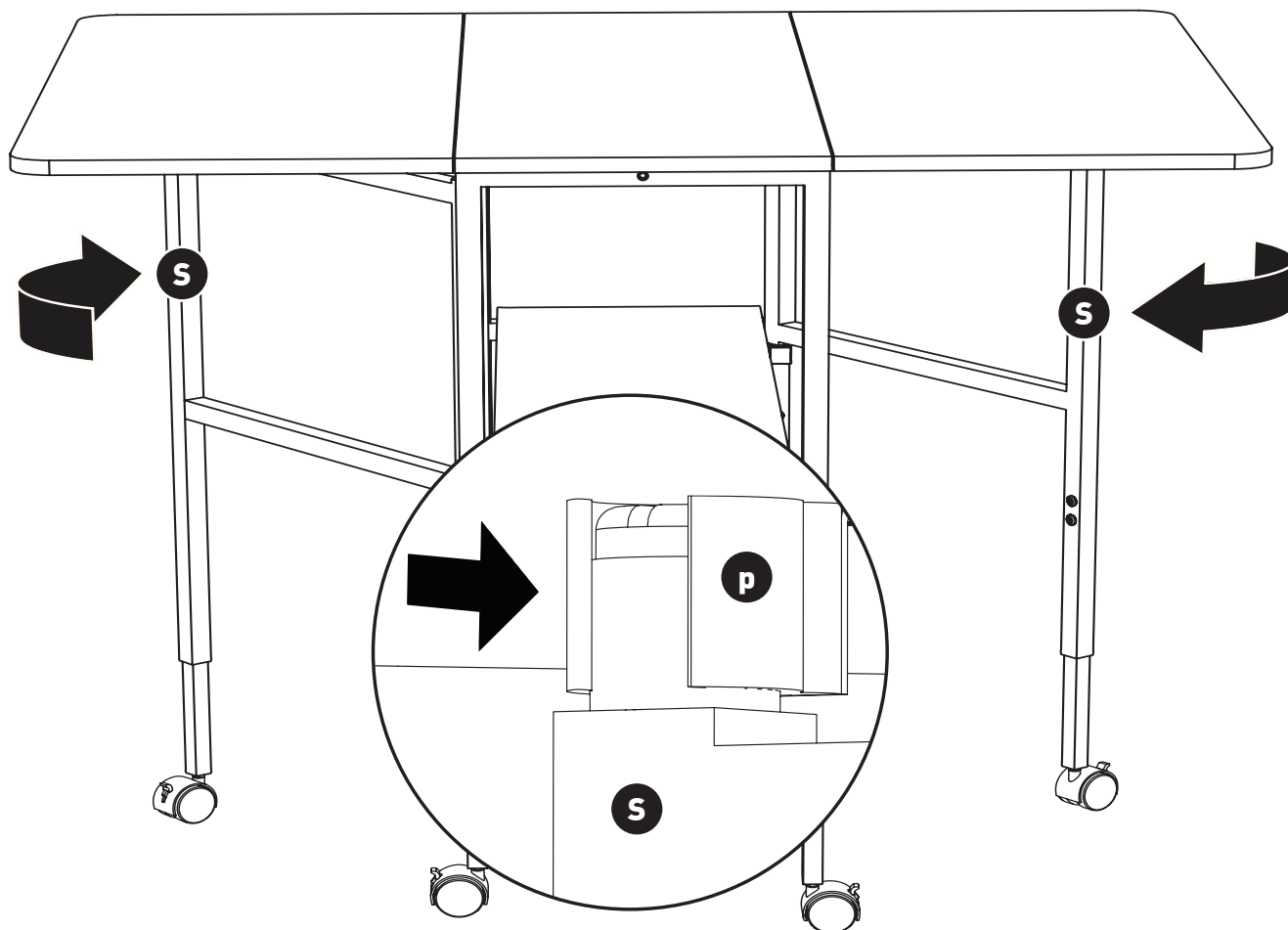
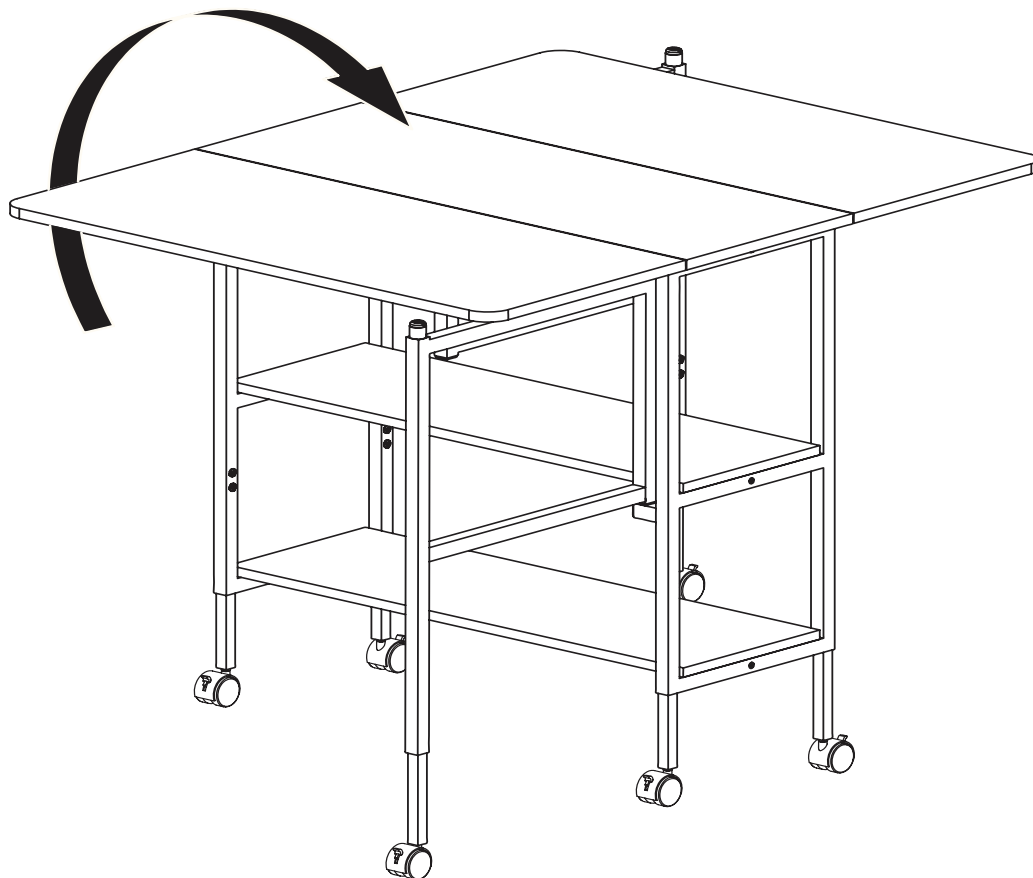


Step 8. Attach plastic support tube (p) and connector (b) assembly with screws (s1) firmly on both sides (A1) following the predrilled holes as shown on the illustration below.

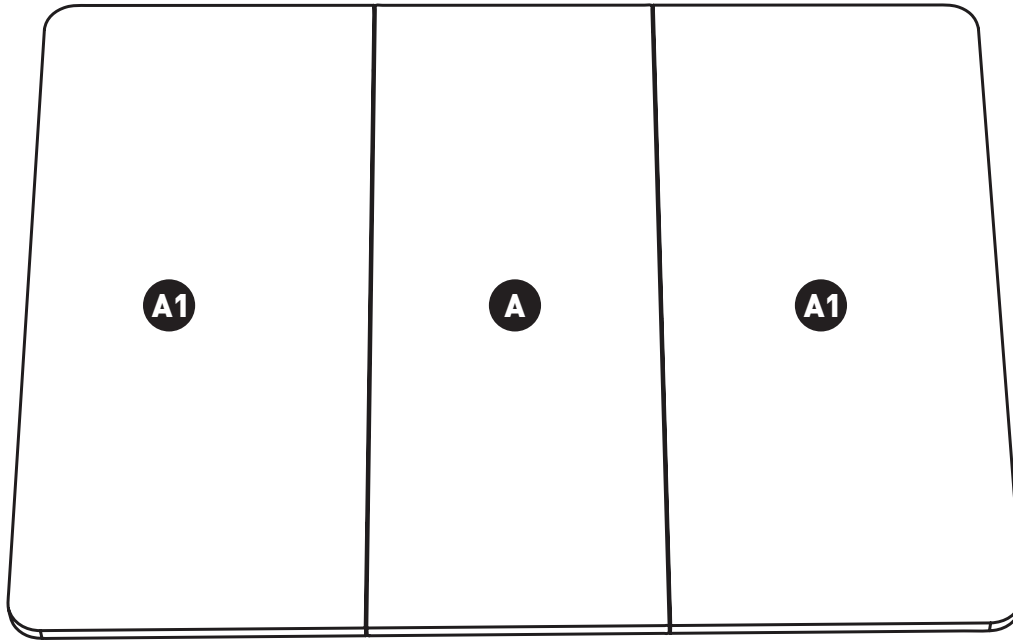


Two people should flip entire assembly and make sure all legs contact the ground and side leg

supports are properly snapped to its connectors on both side before use.



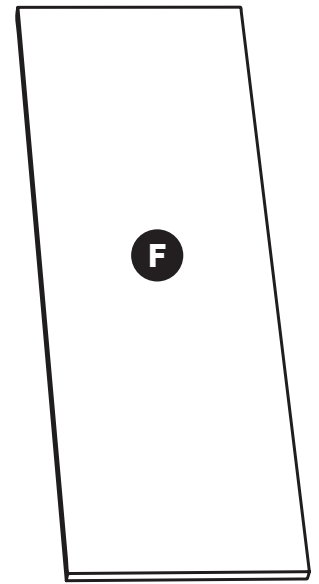
Wood Parts and Part Numbers



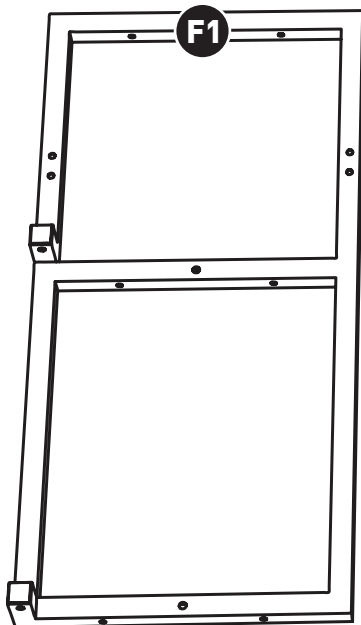
Leaf Panel

Top Panel

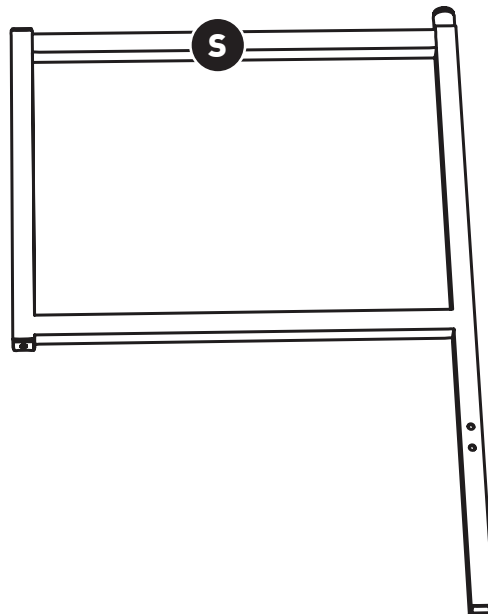
Leaf Panel



Fixed Shelf



Frame Leg Support



Side Leg Support



Adjustable Leg with Caster

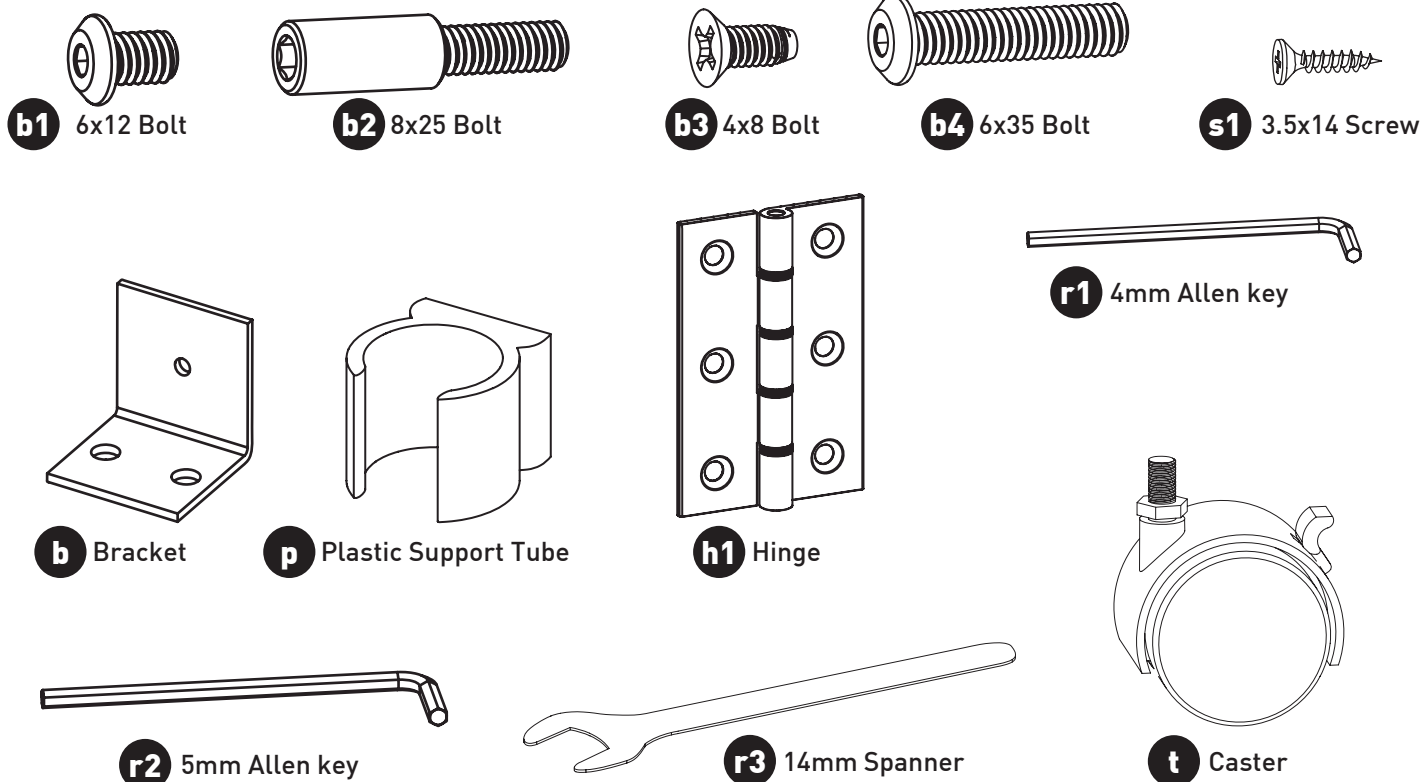


Rail

Wood Parts and Part Numbers

Ref.	Description	Part#					
	Cabinet Model#	3401 (White)					
A	Top Panel	3401PARTA					
A1	Leaf Panel	3401A1					
F	Fixed Shelf	3401F					
F1	Frame Leg Support	3401F1					
S	Side Leg Support	3401S					
L	Adjustable Leg with Caster	3401L					
R	Rail	3401R					

Hardware Included with Part Numbers



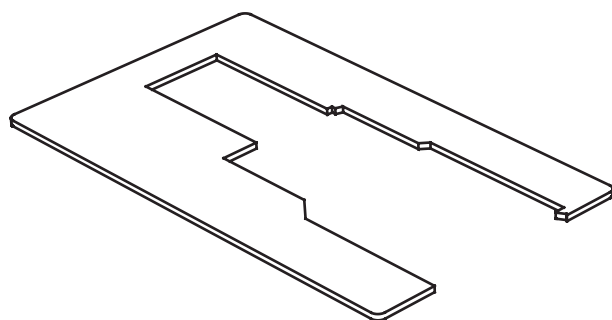
Item	Description	Part No.
B1	6x12 Bolt	3401B1
B2	8x25 Bolt	3401B2
B3	4x8 Bolt	3401B3
B4	6x35 Bolt	3401B4
B	Bracket	3401B
P	Plastic Support Tube	3401P
H1	Hinge	3401H1
R1	4mm Allen Key	3401R1
R2	5mm Allen Key	3401R2
R3	14mm Spanner	3401R3
S1	3.5x14 Screw	3401S1
T	Caster	3401T



Accessories to Complete Your Sewing Experience

Custom Insert

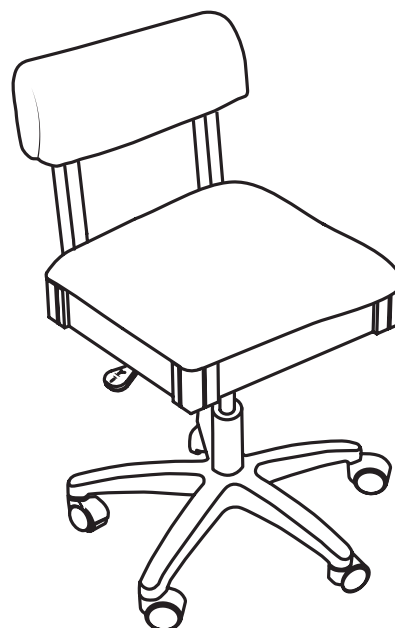
Enhance your sewing experience with a custom-made insert for your Arrow or Kangaroo cabinet. Inserts are designed to reduce the gap between the machine and cabinet opening. This provides an ergonomic work surface for the free arm of the sewing machine, allowing for straighter stitches, less fatigue and an overall better experience using your machine and cabinet.



Insert

Arrow Sewing Chairs

Our adjustable height sewing chair is a perfect accessory for any craft and sewing room. The chair's height is adjustable with easy to use controls and the cushions provide perfect lumbar support and comfort for those long sewing hours. Chair features five casters on a star base for greater movement at your sewing cabinet or crafting surface. Lift the seat cushion to reveal a hidden storage compartment for your small notions or patterns.



Hydraulic Sewing Chair

P.O. Box 307 Delavan, WI 53115
1-800-533-7347 Ext. 1
cs@arrowcabinets.com
www.arrowcabinets.com