

# MODEL: A680 PARTS DRAWING

6/20/2018

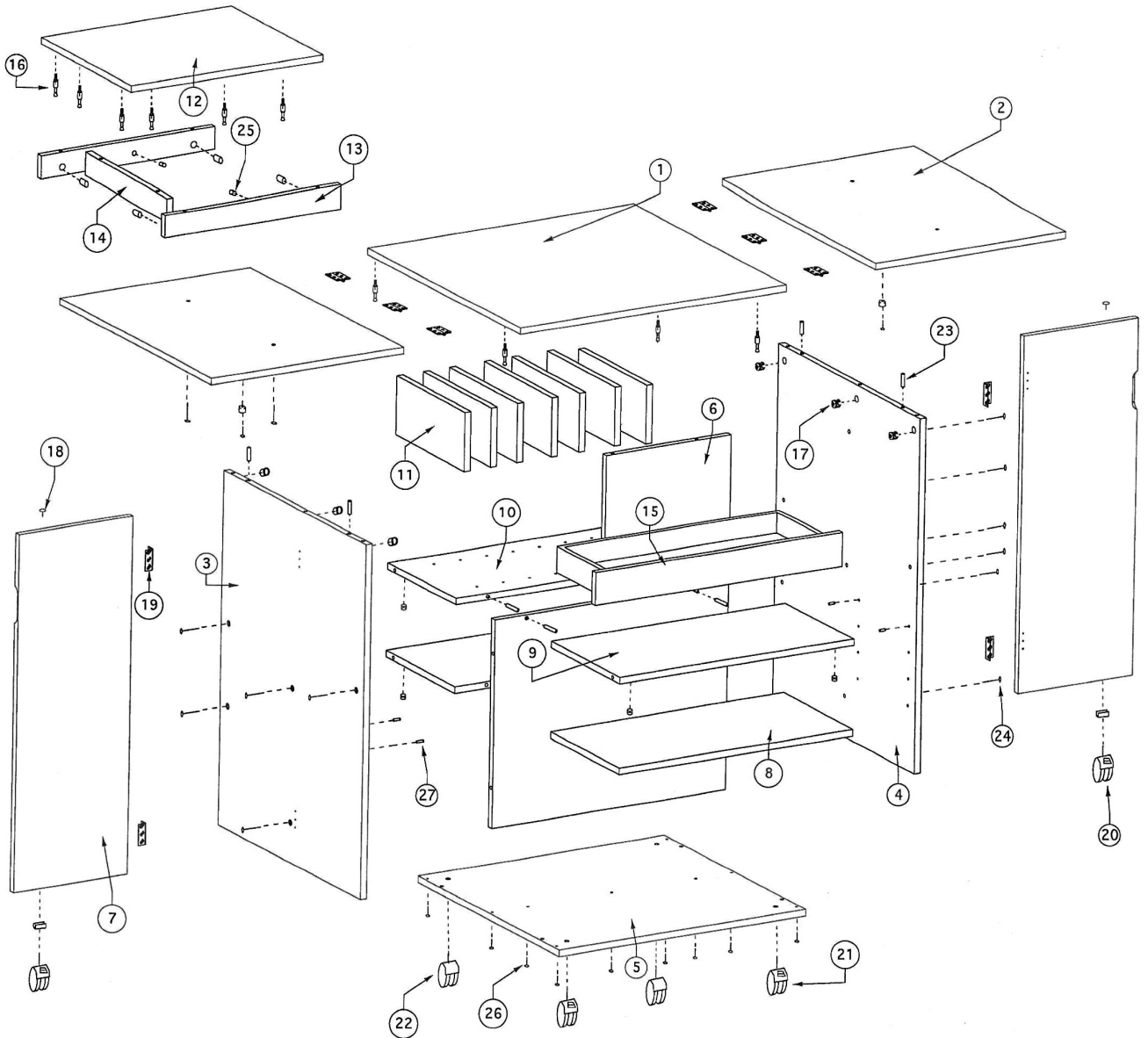

<u>PART NO.</u>	<u>DESCRIPTION</u>	<u>QTY. REQ.</u>	<u>PART NO.</u>	<u>DESCRIPTION</u>	<u>QTY. REQ.</u>
A680-1	TOP	1	A680-15	DRAWER	1
A680-2	DROP LEAF	2	A680-16	CAM LOCK PIN	12
A680-3	LEFT SIDE PANEL	1	A680-17	CAM LOCK	9
A680-4	RIGHT SIDE PANEL	1	A680-18	GLIDE TACK	2
A680-5	BOTTOM	1	A680-19	BUTT HINGE W/SCREWS	10
A680-6	CENTER PANEL	1	A680-20	PUSH-IN LOCK CASTER	2
A680-7	SUPPORT PANEL	2	A680-21	5/16" THREAD LOCK CASTER	2
A680-8	ADJUSTABLE SHELF	1	A680-22	5/16" THREAD NON-LOCK CASTER	2
A680-9	STATIONARY SHELF	2	A680-23	WOODEN DOWEL	5
A680-10	DEVIDER SHELF	1	A680-24	2" CONNECTOR BOLT	13
A680-11	SHELF DIVIDER	7	A680-25	BARREL NUT 5/8"	13
A680-12	RISER TOP	1	A680-26	SCREW	9
A680-13	RISER SIDE RAIL	2	A680-27	SHELF PINS	4
A680-14	RISER BOTTOM CLEAT	1	A680-28	5/8 CASTER "U" BRACKET	2

NOTE: WHEN ORDERING REPLACEMENT PARTS, PLEASE SPECIFY PART NUMBER \_\_\_\_\_ AND COLOR \_\_\_\_\_.

HORN OF AMERICA, INC.  
P.O. BOX 608  
SUTTON, WV 26601  
PH: (800) 882-8845

# MODEL: A680 ASSEMBLY INSTRUCTIONS

10/24/2018

1. AFTER OPENING CARTON, REMOVE INNER CARTON AND INSTALL CASTERS TO CABINET AS SHOWN IN FIGURE #1. GENTLY ROLL CABINET OVER AND SET UP ON CASTERS.

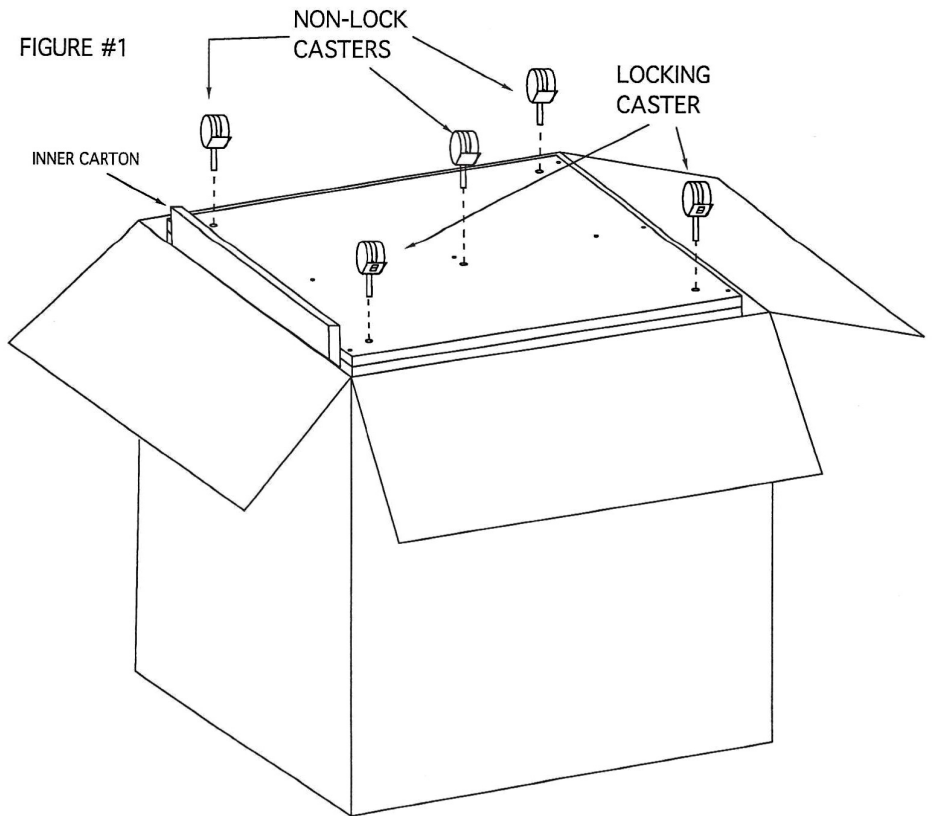

2. REMOVE CONTENTS FROM INNER CARTON AND PLACE ON FLAT WORKING SURFACE. PLACE RISER TOP WITH WITH 5MM HOLES FACING UP. NEXT ATTACH CAM LOCK PINS TO RISER TOP USING PRE-DRILLED HOLES. ALIGN HOLES IN RISER END RAILS WITH CAM LOCK PINS ON RISER TOP AND SECURE BY USING A SCREW DRIVER TO TURN CAM LOCK CLOCKWISE TO TIGHTEN. AS SHOWN IN FIGURE #2 BELOW.

FIGURE #2

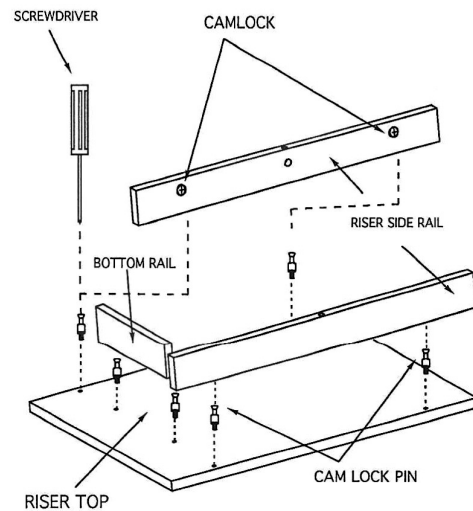

# MODEL: A680 ASSEMBLY INSTRUCTIONS

10/24/2018

3. USING THE PROVIDED 2" CONNECTOR BOLTS, INSERT THROUGH THE BOTTOM OF THE DROP LEAF CONNECTING RISER TO DROPLEAF.

NOTE: RISER CAN BE ATTACHED TO EITHER DROP LEAF.

