

# scallops — off the edge

*A delicate edge finish sewing a corded scallop stitch off the edge.*

1. Sew the scallop along a finished edge. Place a piece of tear-away stabilizer under the edge. Select the scallop stitch and adjust the stitch length to a satin stitch. Place the gimp cord under the back of the foot. Begin stitching making sure the cord is caught in the stitching. Once the gimp cord is caught in the scallop stitch it should just follow the needle and the thread. (#1)

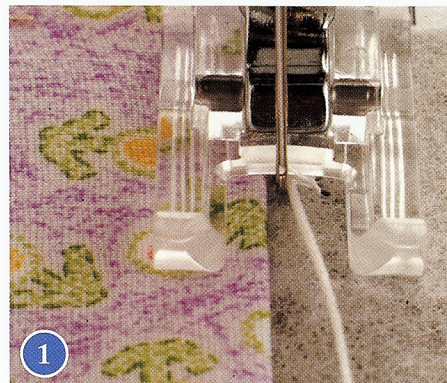

2. As you sew, the point of the scallop should just catch the edge of the fabric with the remaining stitches falling into the stabilizer. (#2)



3. Build more rows of scallop stitches onto the first row. Make sure the stabilizer is wide enough to accommodate the extra rows. If not just add more under the edge. Start the second row of scallops in the middle of the previous row. The machine should track relatively accurately with the point of the scallop stitching into the previous row. If not raise the presser foot with the presser foot lifter and adjust the foot slightly. (#3)

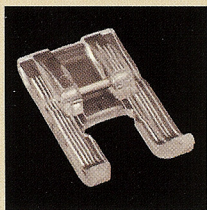
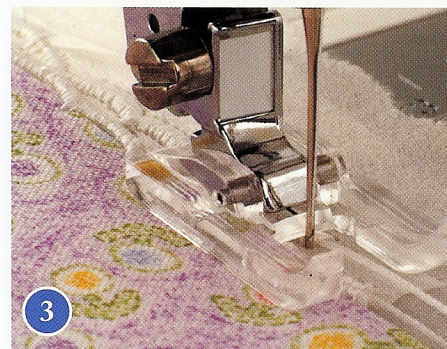

**Open Toe Foot**

**Stitch:** Scallop Stitch

**Width:** Pre-set

**Length:** 0.3mm

**Tension:** Pre-set

**Fabric, needles, notions required:**

*Fabrics of choice; universal or embroidery needle, size 80/12 or 75/11; rayon or cotton embroidery thread for needle and bobbin; gimp cord; heavy tear-away stabilizer*

**TIP**

*Use multiple layers or a heavy weight stabilizer to sew the scallops off the edge. Carefully remove the stabilizer from behind the scallop stitch and pick off any remains with tweezers.*