

# decorative stitch appliqué

*An appliqué technique using decorative stitches to sew the pieces to the background fabric.*

1. Trace the design to the paper on one side of double stick fusible web as is done for satin stitch appliqué. Remove the paper from one side and fuse to the wrong side of the appliqué fabric.
2. Following the drawn line, cut out the appliqué piece. Always working from the bottom out, fuse the bottom piece to the right side of the background fabric. (#1)
3. Layer the fabric over the tear-away stabilizer. Select a decorative stitch and center the suggested presser foot, either the open toe or monogramming foot, on the edge and begin stitching around the design. Using your presser foot lifter, pivot around curves and corners. Lockstitch at the end. (#2)
4. Continue to layer the appliqué pieces on top and stitch. Carefully remove the tear-away stabilizer from the back.

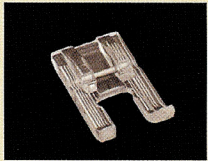
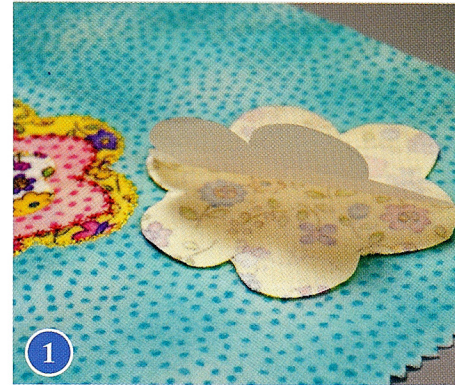

Open Toe

or

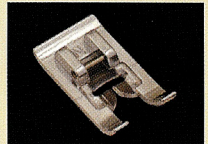

Monogramming Foot

**Stitch:** *Decorative stitch of choice*

**Width:** *Reduce according to size of appliqué pieces*

**Length:** *Pre-set*

**Tension:** *Pre-set*

**Fabric, needles, notions required:**

*Cotton solids or prints; universal or embroidery needle, size 80/12 or 75/11; rayon or cotton embroidery thread for needle and bobbin on bobbin; double stick fusible web; tear-away stabilizer; marking pen or pencil; appliqué scissors*

**TIP**

*When selecting a decorative stitch to outline your applique, the best stitches to choose are stitches that are balanced on the right and left side. First, test sew the stitch counting the stitches as you sew. In applying the appliqué piece, count the stitches based on your test to know when to pivot to keep the stitch formed correctly for stitching around corners and curves.*